

Historic Cultural Properties Inventory (HCPI) Base Form (FORM 1)

Historic Preservation Division, New Mexico Office of Cultural Affairs

For HPD Office use only: HCPI No. District No. NRHP: SRCP: Criteria: A B C D

NAME OF PROPERTY: **Paseo del Pueblo Norte 146 - William T. Hinde House** LOCAL REFERENCE NUMBER: **2005007**
LOCATION OF PROPERTY: **146 PASEO DEL PUEBLO NORTE** UTM ZONE:
CITY OR TOWN: **Taos** UTM EASTING:
COUNTY: **Taos** UTM NORTHING:

DATE OF SURVEY:

2/18/2005

PREVIOUS SURVEY?

Not Available

PREVIOUS SURVEY DATE:

Not Available

NAME OF PROJECT:

2005 CLG Survey

PHOTOGRAPH:

ROLL NUMBER:

FRAME NUMBER:

NEGATIVE LOCATION:



PROPERTY TYPE: **Primary** PHOTOGRAPH VIEW: **2005 Survey Photo 1**

DESCRIPTION OF PROPERTY:

146 Paseo del Pueblo Norte is a single story white stuccoed adobe residence with an undulating parapet that steps up at the building corners. It displays features of the Bungalow and Craftsman styles. Windows are paired wooden double-hung one-over-one units. There are two fixed plate glass units on the north elevation and a bay window on the south elevation. A full-width porch with exposed joists, a shed roof, chamfered concrete posts, and river rock knee wall embellishes the east elevation. There is a single exterior chimney on the north elevation at the east end. The main entrance is through a single leaf wood panel and single window door with side lights and a wrought iron screen door. The site is framed with streets on 3 sides. There is a low twisted wire fence around the property perimeter with a pedestrian gate and concrete piers at the east side of the property. The building is surrounded by mature evergreen trees which make it difficult to fully view its architectural elements.

CONSTRUCTION DATE KNOWN? **Yes** SOURCE FOR CONSTRUCTION DATE: **Eleanor B Hallstrom**

CONSTRUCTION DATE: **1916** to **1916**

SIGNIFICANT MODIFICATIONS? **pre-1957 addition on west/rear**

NOTES ON CONDITION: **Fair**

WHO USES THE PROPERTY?: **Single family residential [rental]**

SETTING: **Urban**

RELATIONSHIP TO SURROUNDINGS: **Dis-similar**

IF URBAN SETTING, NATURE OF IT:

COMMENTS ON SURROUNDINGS:

ADDITIONAL PERSPECTIVE: (Photo, drawing, footprint, etc.; indicate north arrow when possible)



NOTES ON ADDITIONAL PERSPECTIVE: (If photo, include photo info, as in #10)

SURVEYOR BUSINESS NAME:

OWNER OR OTHER KNOWLEDGEABLE PEOPLE:

SURVEYOR FIRST NAME:

Eleanor B Hallstrom

SURVEYOR LAST NAME: Ragins

SURVEYOR STREET ADDRESS: 9 Stone ridge Road

IS THE PROPERTY ENDANGERED?: NO

SURVEYOR CITY: Santa Fe

HOW IS THE PROPERTY ENDANGERED?:

SURVEYOR ZIP CODE: 87505

SURVEYOR TELEPHONE: 575.995.0852

SURVEYOR EMAIL:

Previously surveyd as #022503024. House was built by Abe and Bing Abbot for Mr. Hinde who was the town blacksmith and originally from England. The building was previously addressed as 401 Paseo del Pueblo Norte. It is on Tract 213, # 1-074-149-379-028. The Taos County Reassessment Survey describe the house as one

SIGNIFICANCE TO CURRENT COMMUNITY: High

DESCRIPTION OF COMMUNITY SIGNIFICANCE: unique style and intact historic and architectural integrity

OTHER INFORMATION OF INTEREST: (Such as historical, legendary, structural, former ownership, etc.)

Previously surveyd as #022503024. House was built by Abe and Bing Abbot for Mr. Hinde who was the town blacksmith and originally from England. The building was previously addressed as 401 Paseo del Pueblo Norte. It is on Tract 213, # 1-074-149-379-028. The Taos County Reassessment Survey describe the house as one story, six room adobe. The historic information reflected herein also came from the William Hinde/Brink Family Photo Album. Garage and workshop on site is surveyed separately as # 2005008.

Construction Date From: 1941Taos County Reassessment Survey

Individual Building Status

IS PROPERTY INDIVIDUALLY LISTED ON A REGISTER?:

INDIVIDUALLY LISTED ON SRCP?: NO

INDIVIDUALLY LISTED ON NRHP?: NO

IF NOT LISTED, IS IT ELIGIBLE?:

IF ELIGIBLE, WHY?:

Building Located In A Special Historic District?

IS PROPERTY IN SPECIAL HISTORIC DISTRICT? YES

DISTRICT NAME AND STATUS:

Taos Downtown Historic District - SRCP NO

La Loma Plaza Historic District - SRCP NO

Taos Historic Overlay Zone - Taos Only YES

Historic Cultural Properties Inventory (HCPI) Detail Form (Form 2)

Historic Preservation Division, New Mexico Office of Cultural Affairs >>Complete HCPI Form 1 before Form 2<<

For HPD Office use only: HCPI No. District No. LOCAL REFERENCE NUMBER: 2005007
NAME OF PROPERTY: Paseo del Pueblo Norte 146 - William T. Hinde Ho LOCATION OF PROPERTY: 146 PASEO DEL PUEBLO NOR
COUNTY: Taos CITY OR TOWN: Taos DATE OF SURVEY: 2/18/2005

ARCHITECTURAL AND CONSTRUCTION DETAILS

STORIES ABOVE GRADE? 1.0

CONSTRUCTION MATERIAL:

PRIMARY VISIBLE CONSTRUCTION MATERIAL: General

NOTES ON VISIBLE CONSTRUCTION MATERIAL: low twisted wire fence around the property perimeter with a pedestrian gate and

FOUNDATION:

DOES A FOUNDATION EXIST?:

TYPE OF FOUNDATION:

FOUNDATION MATERIALS

FOUNDATION NOTES:

GENERAL: Notes

Details

concrete piers on the gate are crumbled and there is exposed re-bar

EXTERIOR: Notes

Details

low twisted wire fence around the property perimeter with a pedestrian gate and concrete piers at the east side of the property.

ROOF: Notes

Details

Flat
Low
Stepped Parapet

DOORS: Notes

Details

single window, side lights, wrought iron screen door.

Wood
Panel
Windows/Lites

WINDOWS: Notes

Details

2 fixed plate glass units

Double Hung
Glazed
One-over-one units.

PORCHES/PORTALES: Notes

Details

exposed joists, shed roof, chamfered concrete posts, river rock knee wall

CHIMNEYS: Notes

Details

exterior, on north elevation, east end.

EXTERIOR WALLS : Notes

Details

Not Available

LANDSCAPING: Notes

Details

surrounded by mature evergreen trees which make it difficult to fully view its architectural elements.

OTHER SIGNIFICANT FEATURES Describe unique features.)

[Empty box for other significant features]

MODIFICATIONS: (For each entry, indicate source of the date. Enter "surveyor" if it is your own. If prior survey, give date.)

pre-1957 addition on west/rear

PRIMARY ARCHITECTURAL STYLE:

Bungalow/Craftsman

concrete piers on the gate are crumbled and there is exposed re-bar

SITE PLAN:

(Include footprint of building, porches and balconies, major landscape features, associated properties, walls, fences, gates, nearby roads, driveways, and north arrow.)

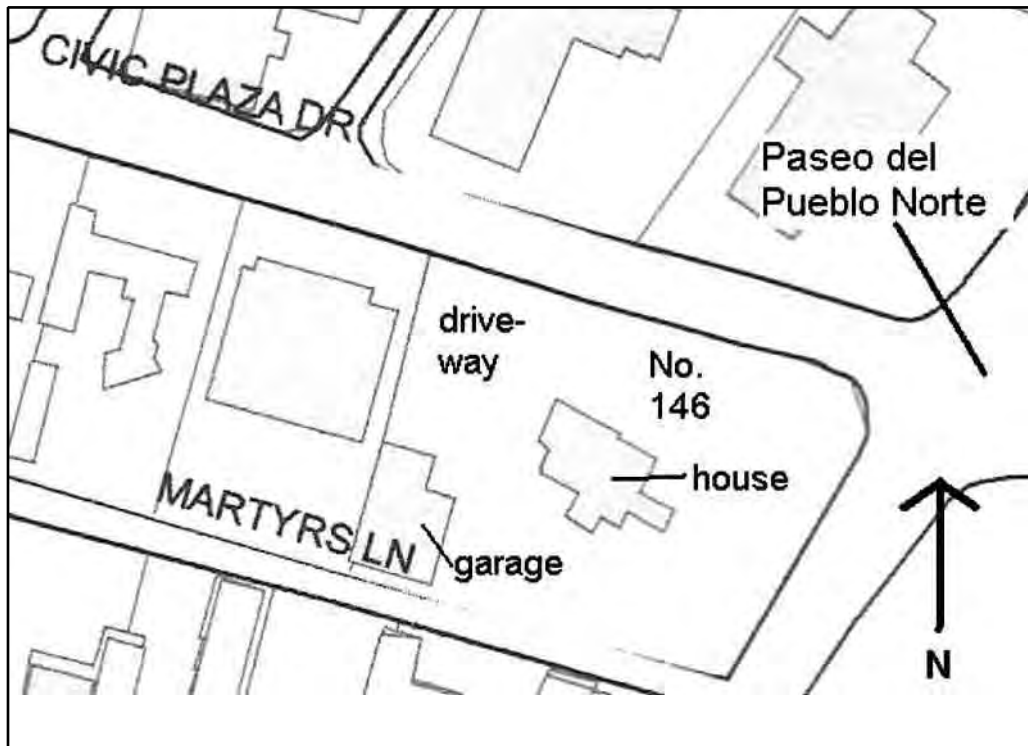

LOCATION OF, AND AVAILABLE DOCUMENTS

(Plans, histories, oral histories, maps, aerial photos, bibliographic references, etc. and where they can be found.)

[Empty box for location of and available documents]

SITE PLAN NOTES:

Site. Base map provided by Taos GIS. NTS.

ATTACHED OR ASSOCIATED PROPERTIES:

(List and describe. Indicate whether surveys exist for these and provide survey numbers if known.)

DESCRIPTION OF ATTACHED OR ASSOCIATED PROPERTIES:

Previously surveyd as #022503024. House was built by Abe and Bing Abbot for Mr. Hinde who was the town blacksmith and originally from England. The building was previously add

IF SO, ARE THEY ELIGIBLE FOR LISTING?: None