

Historic Cultural Properties Inventory (HCPI) Base Form (FORM 1)

Historic Preservation Division, New Mexico Office of Cultural Affairs

For HPD Office use only: HCPI No. District No. NRHP: SRCP: Criteria: A B C D

NAME OF PROPERTY: **Martyrs Ln 105 - William T. Hinde Garage and Shop**

LOCAL REFERENCE NUMBER: **2005008**

LOCATION OF PROPERTY: **146 PASEO DEL PUEBLO NORTE**

UTM ZONE:

CITY OR TOWN: **Taos**

UTM EASTING:

COUNTY: **Taos**

UTM NORTHING:

DATE OF SURVEY:

2/18/2005

PREVIOUS SURVEY?

Not Available

PREVIOUS SURVEY DATE:

Not Available

NAME OF PROJECT:

2005 CLG Survey

PHOTOGRAPH:

ROLL NUMBER:

FRAME NUMBER:

NEGATIVE LOCATION:



PROPERTY TYPE: **Primary**

PHOTOGRAPH VIEW: **2005 Survey Photo 1**

DESCRIPTION OF PROPERTY:

The Garage and Workshop at 146 Paseo del Pueblo Norte is a single story painted stucco structure with a gable roofline. The building's characteristic east parapet follows the gable form and steps up at the corners. There is a pair of 8-lite wooden casement windows on the south elevation. Roof joists project beyond the eaves. There are two wooden painted [blue] vertical slat doors on the east elevation which reflect the historic usage of the structure, one vehicular and one pedestrian. Lintels over the doors are exposed as are some viga ends on the south. The building sits at the southwest corner of its site with direct south frontage on Martyrs Lane. A chicken wire fence runs along the south side of the property.

CONSTRUCTION DATE KNOWN? **Yes** SOURCE FOR CONSTRUCTION DATE: **Eleanor B Hallstrom**

CONSTRUCTION DATE: **1916** to **1916**

SIGNIFICANT MODIFICATIONS? **post-1957 addition on east elevation, partial infill of window on south**

NOTES ON CONDITION: **Fair**

WHO USES THE PROPERTY?: **part of rental property on larger site**

SETTING: **Urban**

RELATIONSHIP TO SURROUNDINGS: **Dis-similar**

IF URBAN SETTING, NATURE OF IT:

COMMENTS ON SURROUNDINGS:

ADDITIONAL PERSPECTIVE: (Photo, drawing, footprint, etc.; indicate north arrow when possible)



NOTES ON ADDITIONAL PERSPECTIVE:
(If photo, include photo info, as in #10)

SURVEYOR BUSINESS NAME:

OWNER OR OTHER KNOWLEDGEABLE PEOPLE:

SURVEYOR FIRST NAME:

Eleanor B Hallstrom

SURVEYOR LAST NAME: Ragins

SURVEYOR STREET ADDRESS: 9 Stone ridge Road

IS THE PROPERTY ENDANGERED?: NO

SURVEYOR CITY: Santa Fe

HOW IS THE PROPERTY ENDANGERED?:

SURVEYOR ZIP CODE: 87505

SURVEYOR TELEPHONE: 575.995.0852

SURVEYOR EMAIL:

Previously surveyd as part of #022503024. House was built by Abe and Bing Abbot for Mr. Hinde who was the town blacksmith and originally from England. The property was previously addressed as 401 Paseo del Pueblo Norte. It is on Tract 213, # 1-074-149-379-028. The Taos County Reassessment Survey describe the shop and

SIGNIFICANCE TO CURRENT COMMUNITY: High

DESCRIPTION OF COMMUNITY SIGNIFICANCE: strong historic associations and architectural integrity intact

OTHER INFORMATION OF INTEREST: (Such as historical, legendary, structural, former ownership, etc.)

Previously surveyd as part of #022503024. House was built by Abe and Bing Abbot for Mr. Hinde who was the town blacksmith and originally from England. The property was previously addressed as 401 Paseo del Pueblo Norte. It is on Tract 213, # 1-074-149-379-028. The Taos County Reassessment Survey describe the shop and garage as one-room frame buildings built in 1916. According to Sanborn Map review, the northern portion of the building was constructed between 1929 and 1939. The historic information reflected herein also came from the William Hinde/Brink Family Photo Album. The main house on the site is surveyed as #2005007.

Construction Date From: 1941 Taos County Reassessment Survey

Individual Building Status

IS PROPERTY INDIVIDUALLY LISTED ON A REGISTER?:

INDIVIDUALLY LISTED ON SRCP?: NO

INDIVIDUALLY LISTED ON NRHP?: NO

IF NOT LISTED, IS IT ELIGIBLE?:

IF ELIGIBLE, WHY?:

Building Located In A Special Historic District?

IS PROPERTY IN SPECIAL HISTORIC DISTRICT? YES

DISTRICT NAME AND STATUS:

Taos Downtown Historic District - SRCP NO

La Loma Plaza Historic District - SRCP NO

Taos Historic Overlay Zone - Taos Only YES

Historic Cultural Properties Inventory (HCPI) Detail Form (Form 2)

Historic Preservation Division, New Mexico Office of Cultural Affairs >>Complete HCPI Form 1 before Form 2<<

For HPD Office use only: HCPI No. District No. LOCAL REFERENCE NUMBER: 2005008
NAME OF PROPERTY: Martyrs Ln 105 - William T. Hinde Garage and Sh LOCATION OF PROPERTY: 146 PASEO DEL PUEBLO NOR
COUNTY: Taos CITY OR TOWN: Taos DATE OF SURVEY: 2/18/2005

ARCHITECTURAL AND CONSTRUCTION DETAILS

STORIES ABOVE GRADE? 1.0

CONSTRUCTION MATERIAL:

PRIMARY VISIBLE CONSTRUCTION MATERIAL:

NOTES ON VISIBLE CONSTRUCTION MATERIAL: Projecting roof joists beyond eaves.

FOUNDATION:

DOES A FOUNDATION EXIST?:

TYPE OF FOUNDATION:

FOUNDATION MATERIALS

FOUNDATION NOTES:

GENERAL: Notes

Details

peeling paint, apparent structural cracking on west

EXTERIOR: Notes

Details

Projecting roof joists beyond eaves.

Viga Tails

ROOF: Notes

Details

Gabled
Low
Stepped Parapet on east

DOORS: Notes

Details

Painted blue vertical slat doors, one vehicular and one pedestrian

WINDOWS: Notes

Details

Casement
Unglazed
Divided Light 9-lite

PORCHES/PORTALES: Notes

Details

Not Available

CHIMNEYS: Notes

Details

Not Available

EXTERIOR WALLS : Notes

Details

Not Available

LANDSCAPING: Notes

Details

Not Available

LOCAL REFERENCE NUMBER:

OTHER SIGNIFICANT FEATURES Describe unique features.)

[Empty box for other significant features]

MODIFICATIONS: (For each entry, indicate source of the date. Enter "surveyor" if it is your own. If prior survey, give date.)

[Empty box for modifications]

PRIMARY ARCHITECTURAL STYLE:

peeling paint, apparent structural cracking on west

Northern New Mexico

SITE PLAN:

(Include footprint of building, porches and balconies, major landscape features, associated properties, walls, fences, gates, nearby roads, driveways, and north arrow.)

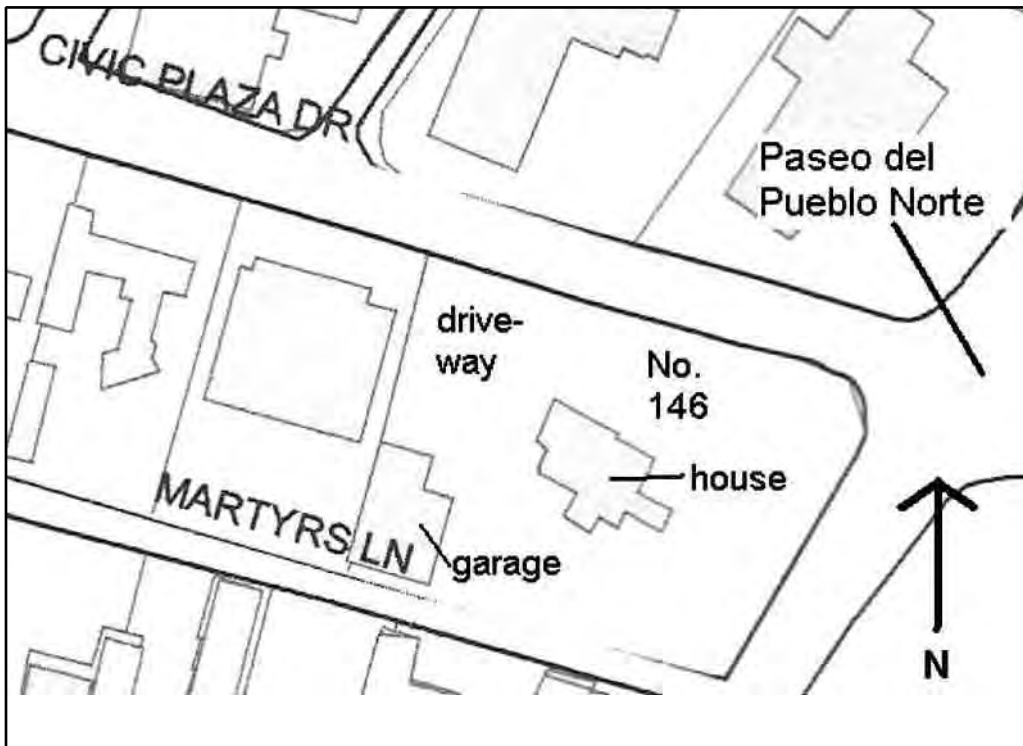

LOCATION OF, AND AVAILABLE DOCUMENTS

(Plans, histories, oral histories, maps, aerial photos, bibliographic references, etc. and where they can be found.)

[Empty box for location of documents]

SITE PLAN NOTES:

Site. Base map provided by Taos GIS. NTS.

ATTACHED OR ASSOCIATED PROPERTIES:

(List and describe. Indicate whether surveys exist for these and provide survey numbers if known.)

DESCRIPTION OF ATTACHED OR ASSOCIATED PROPERTIES:

Previously surveyd as part of #022503024. House was built by Abe and Bing Abbot for Mr. Hinde who was the town blacksmith and originally from England. The property was previou

IF SO, ARE THEY ELIGIBLE FOR LISTING?: None