

Historic Cultural Properties Inventory (HCPI) Base Form (FORM 1)

Historic Preservation Division, New Mexico Office of Cultural Affairs

For HPD Office use only: HCPI No. District No. NRHP: SRCP: Criteria: A B C D

NAME OF PROPERTY: Paseo del Pueblo Norte 212

LOCAL REFERENCE NUMBER: 2005018

LOCATION OF PROPERTY: 212 PASEO DEL PUEBLO NORTE

UTM ZONE:

CITY OR TOWN: Taos

UTM EASTING:

COUNTY: Taos

UTM NORTHING:

DATE OF SURVEY:

2/19/2005

PREVIOUS SURVEY?

Not Available

PREVIOUS SURVEY DATE:

Not Available

NAME OF PROJECT:

2005 CLG Survey

PHOTOGRAPH:

ROLL NUMBER:

FRAME NUMBER:

NEGATIVE LOCATION:



PROPERTY TYPE: Primary

PHOTOGRAPH VIEW: 2005 Survey Photo 1

DESCRIPTION OF PROPERTY:

212 Paseo del Pueblo Norte is a single story stuccoed Spanish Pueblo Revival style residential building with a flat parapet. Windows are recessed 8-lite wooden casement units placed in triplicate. There is a wrap-around flat roofed porch on the east and north elevations with posts, corbels, and an exposed lintel. The posts rest on a knee wall. Entrance to the building is through a centrally located single-leaf vertical panel wooden door with a wood storm/screen. A secondary entrance on the north includes a glass and wood panel unit with sidelights. There is a chimney at the northwest corner of the building. A freestanding historic single car garage with a vertical slat wooden door stands to the north and west of the main structure. The site slopes gently away from street grade.

CONSTRUCTION DATE KNOWN? Yes SOURCE FOR CONSTRUCTION DATE:

CONSTRUCTION DATE: to

SIGNIFICANT MODIFICATIONS?

NOTES ON CONDITION:

WHO USES THE PROPERTY?:

SETTING: Urban

RELATIONSHIP TO SURROUNDINGS: Similar

IF URBAN SETTING, NATURE OF IT:

COMMENTS ON SURROUNDINGS:

Commercial

ADDITIONAL PERSPECTIVE: (Photo, drawing, footprint, etc.; indicate north arrow when possible)

[Large empty rectangular box for additional perspective]

NOTES ON ADDITIONAL PERSPECTIVE: (If photo, include photo info, as in #10)

SURVEYOR BUSINESS NAME:

OWNER OR OTHER KNOWLEDGEABLE PEOPLE:

SURVEYOR FIRST NAME:

SURVEYOR LAST NAME:

SURVEYOR STREET ADDRESS:

IS THE PROPERTY ENDANGERED?: NO

SURVEYOR CITY:

HOW IS THE PROPERTY ENDANGERED?:

SURVEYOR ZIP CODE:

[Empty rectangular box for surveyor zip code]

SURVEYOR TELEPHONE:

SURVEYOR EMAIL:

SIGNIFICANCE TO CURRENT COMMUNITY:

DESCRIPTION OF COMMUNITY SIGNIFICANCE:

OTHER INFORMATION OF INTEREST: (Such as historical, legendary, structural, former ownership, etc.)

[Large empty rectangular box for other information of interest]

Individual Building Status

IS PROPERTY INDIVIDUALLY LISTED ON A REGISTER?:

INDIVIDUALLY LISTED ON SRCP?: YES

INDIVIDUALLY LISTED ON NRHP?: NO

IF NOT LISTED, IS IT ELIGIBLE?:

IF ELIGIBLE, WHY?:

[Empty rectangular box for eligibility reason]

Building Located In A Special Historic District?

IS PROPERTY IN SPECIAL HISTORIC DISTRICT? YES

DISTRICT NAME AND STATUS:

Taos Downtown Historic District - SRCP NO

La Loma Plaza Historic District - SRCP NO

Taos Historic Overlay Zone - Taos Only YES

Historic Cultural Properties Inventory (HCPI) Detail Form (Form 2)

Historic Preservation Division, New Mexico Office of Cultural Affairs >>Complete HCPI Form 1 before Form 2<<

For HPD Office use only: HCPI No. District No. LOCAL REFERENCE NUMBER: 2005018
NAME OF PROPERTY: Paseo del Pueblo Norte 212 LOCATION OF PROPERTY: 212 PASEO DEL PUEBLO NOR
COUNTY: Taos CITY OR TOWN: Taos DATE OF SURVEY: 2/19/2005

ARCHITECTURAL AND CONSTRUCTION DETAILS

STORIES ABOVE GRADE? 1.0

CONSTRUCTION MATERIAL:

PRIMARY VISIBLE CONSTRUCTION MATERIAL: Adobe

NOTES ON VISIBLE CONSTRUCTION MATERIAL: Historic garage to north west.

FOUNDATION:

" Not Available"

GENERAL: Notes

Details

" Not Available"

EXTERIOR: Notes

Details

Historic garage to north west.

Garage

ROOF: Notes

Details

Flat Parapet
Low

DOORS: Notes

Details

with sidelights

Wood
Panel
Glass
Windows/Lites

WINDOWS: Notes

Details

8-lite, triplicate

Casement
Glazed
Divided Light

PORCHES/PORTALES: Notes

Details

North and East elevations, post rests on stucco knee wall

Wrap
Corbels
Round Posts
Exposed Lintels

CHIMNEYS: Notes

Details

Not Available

EXTERIOR WALLS : Notes

Details

Not Available

LANDSCAPING: Notes

Details

LOCAL REFERENCE NUMBER:

OTHER SIGNIFICANT FEATURES *Describe unique features.*

[Empty box for other significant features]

MODIFICATIONS: *(For each entry, indicate source of the date. Enter "surveyor" if it is your own. If prior survey, give date.)*

[Empty box for modifications]

PRIMARY ARCHITECTURAL STYLE:

Spanish-Pueblo Revival

Historic residential area converted to commercial use. Site slopes gently away from street grade.

SITE PLAN:

(Include footprint of building, porches and balconies, major landscape features, associated properties, walls, fences, gates, nearby roads, driveways, and north arrow.)

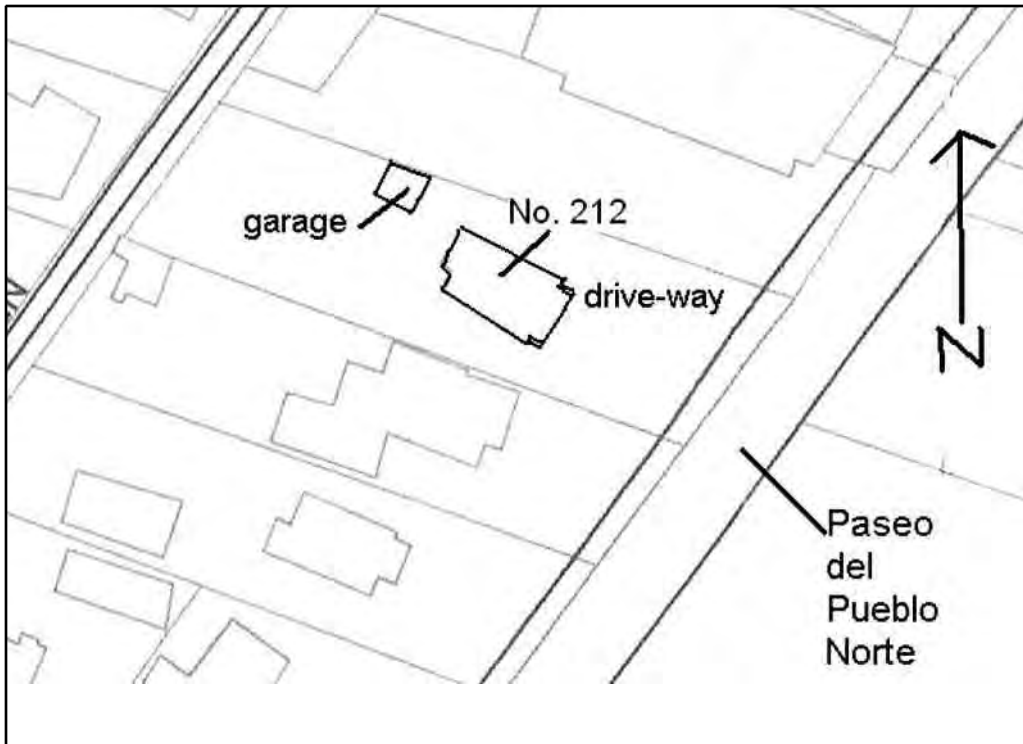

LOCATION OF, AND AVAILABLE DOCUMENTS

(Plans, histories, oral histories, maps, aerial photos, bibliographic references, etc. and where they can be found.)

[Empty box for location of documents]

SITE PLAN NOTES:

Site. Base map provided by Taos GIS. NTS.

(List and describe. Indicate whether surveys exist for these and provide survey numbers if known.)

ATTACHED OR ASSOCIATED PROPERTIES:

DESCRIPTION OF ATTACHED
OR ASSOCIATED PROPERTIES:

The property was surveyed in 1981 as #022503037. The substantial difference in height between the portal and the remainder of the structure may indicate the parapet has been rais

IF SO, ARE THEY ELIGIBLE FOR LISTING?: **None**
