

Historic Cultural Properties Inventory (HCPI) Base Form (FORM 1)

Historic Preservation Division, New Mexico Office of Cultural Affairs

For HPD Office use only: HCPI No. District No. NRHP: SRCP: Criteria: A B C D

NAME OF PROPERTY: **Paseo del Pueblo Norte 308 - Chacon's Accounting** LOCAL REFERENCE NUMBER: **2005029**
LOCATION OF PROPERTY: **308 PASEO DEL PUEBLO NORTE** UTM ZONE:
CITY OR TOWN: **Taos** UTM EASTING:
COUNTY: **Taos** UTM NORTHING:

DATE OF SURVEY:
3/11/2005
PREVIOUS SURVEY?
Not Available

PREVIOUS SURVEY DATE:
Not Available

NAME OF PROJECT:
2005 CLG Survey

PHOTOGRAPH:
ROLL NUMBER:

FRAME NUMBER:

NEGATIVE LOCATION:



PROPERTY TYPE: **Primary** PHOTOGRAPH VIEW: **east and north elevations**

DESCRIPTION OF PROPERTY:

308 Paseo del Pueblo Norte is a single story modern Spanish Pueblo Revival style stuccoed commercial structure with a flat parapet that steps down on the north elevation. Windows are metal large lite slider units [on the east] and fixed large lite units with side sliders on the north. Windows are not recessed into the building walls and have exposed lintels. There is a full-width portal on the east elevation with canales, 6 x 6 square posts with corbels, and an exposed lintel. There is a recessed secondary entrance on the north elevation toward the west end of the building. Entrance to the building is through a single leaf undivided glass metal door with side lites that is centrally located under the portal. The building sits on a corner lot with parking to its west and south. There is a low coyote and railroad tie fence to the building's west.

CONSTRUCTION DATE KNOWN? **Yes** SOURCE FOR CONSTRUCTION DATE:

CONSTRUCTION DATE: to

SIGNIFICANT MODIFICATIONS?

NOTES ON CONDITION:

WHO USES THE PROPERTY?:

SETTING: **Urban**

RELATIONSHIP TO SURROUNDINGS: **Similar**

IF URBAN SETTING, NATURE OF IT:

COMMENTS ON SURROUNDINGS:

Commercial

ADDITIONAL PERSPECTIVE: (Photo, drawing, footprint, etc.; indicate north arrow when possible)

[Large empty rectangular box for additional perspective]

NOTES ON ADDITIONAL PERSPECTIVE: (If photo, include photo info, as in #10)

SURVEYOR BUSINESS NAME:

OWNER OR OTHER KNOWLEDGEABLE PEOPLE:

SURVEYOR FIRST NAME:

SURVEYOR LAST NAME:

SURVEYOR STREET ADDRESS:

IS THE PROPERTY ENDANGERED?: NO

SURVEYOR CITY:

HOW IS THE PROPERTY ENDANGERED?:

SURVEYOR ZIP CODE:

SURVEYOR TELEPHONE:

SURVEYOR EMAIL:

[Empty rectangular box for property endangerment details]

SIGNIFICANCE TO CURRENT COMMUNITY:

DESCRIPTION OF COMMUNITY SIGNIFICANCE:

OTHER INFORMATION OF INTEREST: (Such as historical, legendary, structural, former ownership, etc.)

[Empty rectangular box for other information of interest]

Individual Building Status

IS PROPERTY INDIVIDUALLY LISTED ON A REGISTER?:

INDIVIDUALLY LISTED ON SRCP?: NO

INDIVIDUALLY LISTED ON NRHP?: NO

IF NOT LISTED, IS IT ELIGIBLE?:

IF ELIGIBLE, WHY?:

[Empty rectangular box for eligibility reason]

Building Located In A Special Historic District?

IS PROPERTY IN SPECIAL HISTORIC DISTRICT? YES

DISTRICT NAME AND STATUS:

Taos Downtown Historic District - SRCP NO

La Loma Plaza Historic District - SRCP NO

Taos Historic Overlay Zone - Taos Only YES

Historic Cultural Properties Inventory (HCPI) Detail Form (Form 2)

Historic Preservation Division, New Mexico Office of Cultural Affairs >>Complete HCPI Form 1 before Form 2<<

For HPD Office use only: HCPI No. District No. LOCAL REFERENCE NUMBER: 2005029
NAME OF PROPERTY: Paseo del Pueblo Norte 308 - Chacon's Accounti LOCATION OF PROPERTY: 308 PASEO DEL PUEBLO NOR
COUNTY: Taos CITY OR TOWN: Taos DATE OF SURVEY: 3/11/2005

ARCHITECTURAL AND CONSTRUCTION DETAILS

STORIES ABOVE GRADE? 1.0

CONSTRUCTION MATERIAL:

Not Available

FOUNDATION:

" Not Available"

GENERAL: Notes

" Not Available"

Details

EXTERIOR: Notes

Not Available

Details

ROOF: Notes

Details

Stepped Parapet
Flat

DOORS: Notes

Entrance to the building is through a single leaf undivided glass metal door with side lites that is centrally located under the portal.

Details

Glass
Metal

WINDOWS: Notes

East and North elevations.

Details

Slider
Exposed lintels
Large

PORCHES/PORTALES: Notes

6x6 square posts.

Details

Full
Exposed Lintels
Corbels
Round Posts
Details

CHIMNEYS: Notes

Not Available

Details

EXTERIOR WALLS : Notes

Not Available

LANDSCAPING: Notes

Not Available

Details

LOCAL REFERENCE NUMBER:

OTHER SIGNIFICANT FEATURES Describe unique features.)

Empty box for other significant features.

MODIFICATIONS: (For each entry, indicate source of the date. Enter "surveyor" if it is your own. If prior survey, give date.)

Empty box for modifications.

PRIMARY ARCHITECTURAL STYLE:

single story commercial corridor

Spanish-Pueblo Revival

SITE PLAN:

(Include footprint of building, porches and balconies, major landscape features, associated properties, walls, fences, gates, nearby roads, driveways, and north arrow.)

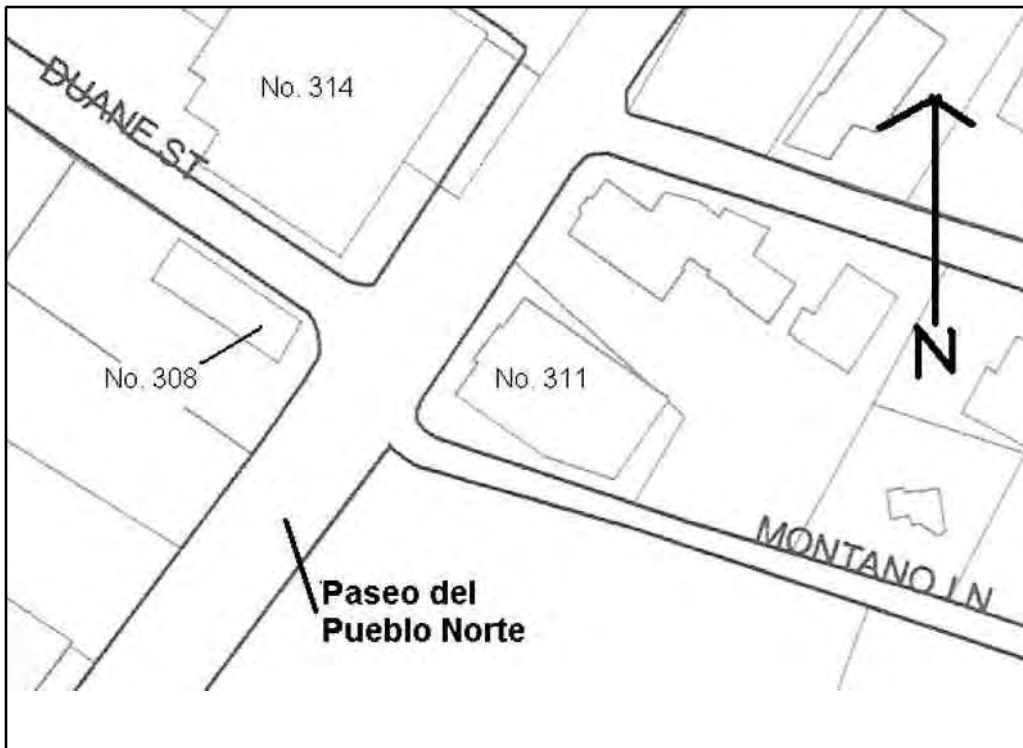

LOCATION OF, AND AVAILABLE DOCUMENTS

(Plans, histories, oral histories, maps, aerial photos, bibliographic references, etc. and where they can be found.)

Empty box for location of and available documents.

SITE PLAN NOTES:

Site. Base map provided by Taos GIS. NTS.

ATTACHED OR ASSOCIATED PROPERTIES: (List and describe. Indicate whether surveys exist for these and provide survey numbers if known.)

DESCRIPTION OF ATTACHED OR ASSOCIATED PROPERTIES

Building stands on Lot 3 of the Van Vecten Subdivision, #1-074-149-458-128.

Construction Date From: Peter Mackaness

IF SO, ARE THEY ELIGIBLE FOR LISTING?: None