

# Historic Cultural Properties Inventory (HCPI) Base Form (FORM 1)

Historic Preservation Division, New Mexico Office of Cultural Affairs

For HPD Office use only: HCPI No.  District No.   NRHP:  SRCP: Criteria:  A  B  C  D

NAME OF PROPERTY: **Paseo del Pueblo Norte 516 - First Indian Baptist Church Parsonage** LOCAL REFERENCE NUMBER: **2005041**  
LOCATION OF PROPERTY: **516 PASEO DEL PUEBLO NORTE** UTM ZONE:  
CITY OR TOWN: **Taos** UTM EASTING:  
COUNTY: **Taos** UTM NORTHING:

DATE OF SURVEY:

**3/11/2005**

PREVIOUS SURVEY?

**Not Available**

PREVIOUS SURVEY DATE:

**Not Available**

NAME OF PROJECT:

**2005 CLG Survey**

PHOTOGRAPH:

ROLL NUMBER:

FRAME NUMBER:

NEGATIVE LOCATION:



PROPERTY TYPE: **Primary**

PHOTOGRAPH VIEW: **west and partial north elevation**

DESCRIPTION OF PROPERTY:

516 Paseo del Pueblo Norte is a two-story Spanish Pueblo Revival style residential building with white stucco. It has a flat parapet which conceals the roof which sheds to the west. Windows are 3-lite metal casement units placed in the walls in pairs and triplicate. Windows have exposed lintels and concrete sills. There is a full-width portal on the north elevation with turned posts and simple corbels. The portal has a flat parapet. Entrance to the structure is through a single leaf carved wooden door under the portal. There is an integrated garage on the east elevation with a similarly carved vehicular door. A projecting balcony on the east elevation second floor has carved wooden posts and railing. An exterior chimney stands on the west elevation. There is a single story shed-roofed addition on the rear which provides a secondary entrance through a single leaf wood and glass panel door. The building is shaded by numerous mature evergreen trees which stand around it.

CONSTRUCTION DATE KNOWN? **Yes** SOURCE FOR CONSTRUCTION DATE:

CONSTRUCTION DATE: to

SIGNIFICANT MODIFICATIONS?

NOTES ON CONDITION:

WHO USES THE PROPERTY?:

SETTING: **Urban**

RELATIONSHIP TO SURROUNDINGS **Dissimilar**

IF URBAN SETTING, NATURE OF IT:

COMMENTS ON SURROUNDINGS:

**Commercial**

ADDITIONAL PERSPECTIVE: (Photo, drawing, footprint, etc.; indicate north arrow when possible)



NOTES ON ADDITIONAL PERSPECTIVE: north and east  
(If photo, include photo info, as in #10)

SURVEYOR BUSINESS NAME: Ragins Research and Planning

OWNER OR OTHER KNOWLEDGEABLE PEOPLE:

SURVEYOR FIRST NAME: Mary

SURVEYOR LAST NAME:

SURVEYOR STREET ADDRESS:

IS THE PROPERTY ENDANGERED?: NO

SURVEYOR CITY:

HOW IS THE PROPERTY ENDANGERED?:

SURVEYOR ZIP CODE:

SURVEYOR TELEPHONE:

SURVEYOR EMAIL:

SIGNIFICANCE TO CURRENT COMMUNITY:

DESCRIPTION OF COMMUNITY SIGNIFICANCE:

OTHER INFORMATION OF INTEREST: (Such as historical, legendary, structural, former ownership, etc.)

**Individual Building Status**

IS PROPERTY INDIVIDUALLY LISTED ON A REGISTER?:

INDIVIDUALLY LISTED ON SRCP?: NO

INDIVIDUALLY LISTED ON NRHP?: NO

IF NOT LISTED, IS IT ELIGIBLE?:

IF ELIGIBLE, WHY?:

**Building Located In A Special Historic District?**

IS PROPERTY IN SPECIAL HISTORIC DISTRICT? YES

DISTRICT NAME AND STATUS:

Taos Downtown Historic District - SRCP NO

La Loma Plaza Historic District - SRCP NO

Taos Historic Overlay Zone - Taos Only YES

# Historic Cultural Properties Inventory (HCPI) Detail Form (Form 2)

Historic Preservation Division, New Mexico Office of Cultural Affairs >>Complete HCPI Form 1 before Form 2<<

For HPD Office use only: HCPI No.  District No.  LOCAL REFERENCE NUMBER: 2005041

NAME OF PROPERTY: Paseo del Pueblo Norte 516 - First Indian Baptist LOCATION OF PROPERTY: 516 PASEO DEL PUEBLO NOR

COUNTY: Taos

CITY OR TOWN: Taos

DATE OF SURVEY: 3/11/2005

## ARCHITECTURAL AND CONSTRUCTION DETAILS

STORIES ABOVE GRADE? 2.0

### **CONSTRUCTION MATERIAL:**

PRIMARY VISIBLE CONSTRUCTION MATERIAL: Adobe

NOTES ON VISIBLE CONSTRUCTION MATERIAL: integrated garage on the east elevation with a similarly carved vehicular door.

### **FOUNDATION:**

" Not Available"

### **GENERAL: Notes**

Details

" Not Available"

### **EXTERIOR: Notes**

Details

integrated garage on the east elevation with a similarly carved vehicular door.

Garage

### **ROOF: Notes**

Details

Sheds to the west.

Flat Parapet  
Low

### **DOORS: Notes**

Details

Not Available

### **WINDOWS: Notes**

Details

3-lite metal casement units placed in the walls in pairs and triplicate. Concrete sills.

Casement  
Exposed lintels

### **PORCHES/PORTALES: Notes**

Details

A projecting balcony on the east elevation second floor has carved wooden posts and railing.

Full  
Carved Posts  
Corbels

### **CHIMNEYS: Notes**

Flat Parapet  
Wood Railing

Not Available

### **EXTERIOR WALLS : Notes**

Details

Not Available

### **LANDSCAPING: Notes**

Details

LOCAL REFERENCE NUMBER:

OTHER SIGNIFICANT FEATURES *Describe unique features.*

**MODIFICATIONS:** *(For each entry, indicate source of the date. Enter "surveyor" if it is your own. If prior survey, give date.)*

**PRIMARY ARCHITECTURAL STYLE:**

two story residence in single story commercial area

Spanish-Pueblo Revival

**SITE PLAN:**

*(Include footprint of building, porches and balconies, major landscape features, associated properties, walls, fences, gates, nearby roads, driveways, and north arrow.)*

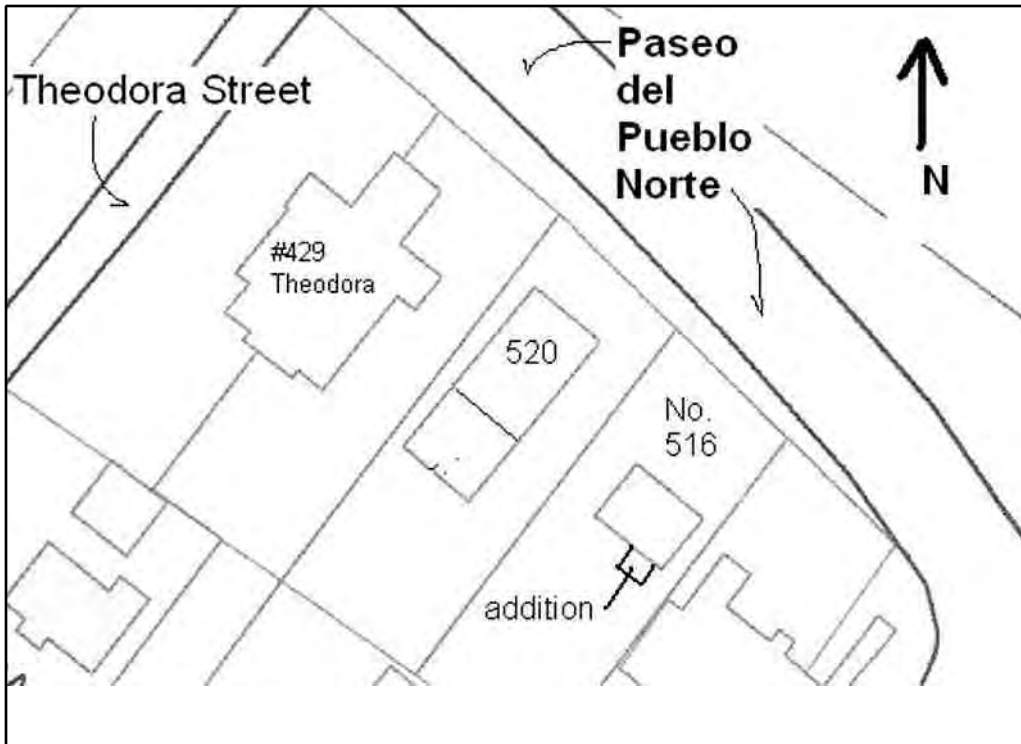

LOCATION OF, AND AVAILABLE DOCUMENTS

*(Plans, histories, oral histories, maps, aerial photos, bibliographic references, etc. and where they can be found.)*

SITE PLAN NOTES:

Site. Base map provided by Taos GIS. NTS.

**ATTACHED OR ASSOCIATED PROPERTIES:** *(List and describe. Indicate whether surveys exist for these and provide survey numbers if known.)*

DESCRIPTION OF ATTACHED  
OR ASSOCIATED PROPERTIES

**Date of structure is based on the known history of the church to the immediate north. This structure is believed to have served as the parsonage for the church when it was built. It still may serve this function.**

IF SO, ARE THEY ELIGIBLE FOR LISTING?: **None**

---