

# Historic Cultural Properties Inventory (HCPI) Base Form (FORM 1)

Historic Preservation Division, New Mexico Office of Cultural Affairs

For HPD Office use only: HCPI No.  District No.   NRHP:  SRCP: Criteria:  A  B  C  D

NAME OF PROPERTY: **Paseo del Pueblo Norte 520 - First Indian Baptist Church**

LOCAL REFERENCE NUMBER: **2005042**

LOCATION OF PROPERTY: **520 PASEO DEL PUEBLO NORTE**

UTM ZONE:

CITY OR TOWN: **Taos**

UTM EASTING:

COUNTY: **Taos**

UTM NORTHING:

DATE OF SURVEY:

**3/11/2005**

PREVIOUS SURVEY?

**Not Available**

PREVIOUS SURVEY DATE:

**Not Available**

NAME OF PROJECT:

**2005 CLG Survey**

PHOTOGRAPH:

ROLL NUMBER:

FRAME NUMBER:

NEGATIVE LOCATION:



PROPERTY TYPE: **Primary**

PHOTOGRAPH VIEW: **East and south elevations**

DESCRIPTION OF PROPERTY:

520 Paseo del Pueblo Norte is a single story simplified Mission Style concrete block structure with a flat parapet and battered corners. A stepped bell tower with exposed lintels anchors the northwest corner of the building. It has buttresses along the east and west elevations. The building is finished with painted stucco [white]. Windows are 3-lite steel casement units set in triplicate with purple glass, and exposed lintels. The front entrance is recessed with an adzed lintel. The main entrance doors are a pair of wood panel units. The building sits slightly below street level. There is a low block/stuccoed yard wall across the front of the property at the street.

CONSTRUCTION DATE KNOWN? **Yes** SOURCE FOR CONSTRUCTION DATE:

CONSTRUCTION DATE: to

SIGNIFICANT MODIFICATIONS?

NOTES ON CONDITION:

WHO USES THE PROPERTY?:

SETTING: **Urban**

RELATIONSHIP TO SURROUNDINGS **Dissimilar**

IF URBAN SETTING, NATURE OF IT:

COMMENTS ON SURROUNDINGS:

**Residential**

ADDITIONAL PERSPECTIVE: (Photo, drawing, footprint, etc.; indicate north arrow when possible)

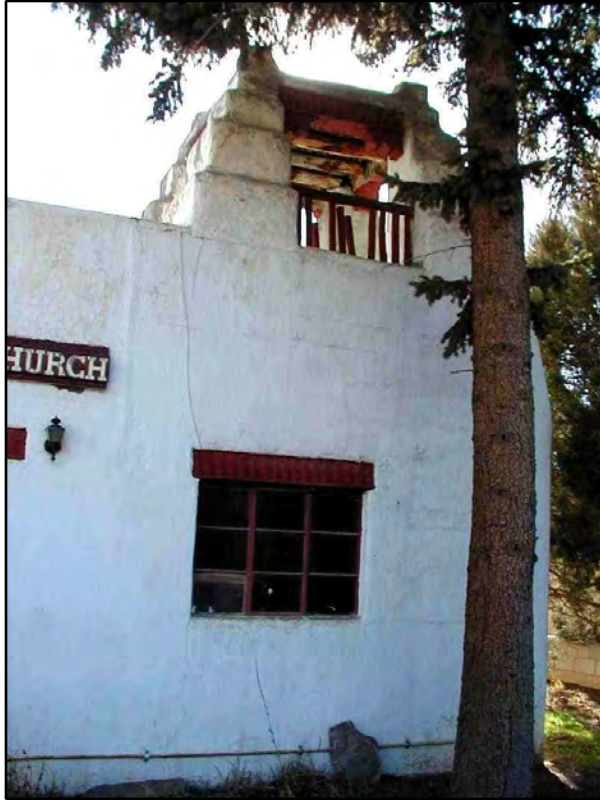

NOTES ON ADDITIONAL PERSPECTIVE: east elevation bell tower  
(If photo, include photo info, as in #10)

SURVEYOR BUSINESS NAME: Ragins Research and Planning

OWNER OR OTHER KNOWLEDGEABLE PEOPLE:

SURVEYOR FIRST NAME: Mary

SURVEYOR LAST NAME:

SURVEYOR STREET ADDRESS:

IS THE PROPERTY ENDANGERED?: NO

SURVEYOR CITY:

HOW IS THE PROPERTY ENDANGERED?:

SURVEYOR ZIP CODE:

SURVEYOR TELEPHONE:

SURVEYOR EMAIL:

SIGNIFICANCE TO CURRENT COMMUNITY:

DESCRIPTION OF COMMUNITY SIGNIFICANCE:

OTHER INFORMATION OF INTEREST: (Such as historical, legendary, structural, former ownership, etc.)

**Individual Building Status**

IS PROPERTY INDIVIDUALLY LISTED ON A REGISTER?:

INDIVIDUALLY LISTED ON SRCP?: NO

INDIVIDUALLY LISTED ON NRHP?: NO

IF NOT LISTED, IS IT ELIGIBLE?:

IF ELIGIBLE, WHY?:

**Building Located In A Special Historic District?**

IS PROPERTY IN SPECIAL HISTORIC DISTRICT? YES

DISTRICT NAME AND STATUS:

Taos Downtown Historic District - SRCP NO

La Loma Plaza Historic District - SRCP NO

Taos Historic Overlay Zone - Taos Only YES

# Historic Cultural Properties Inventory (HCPI) Detail Form (Form 2)

Historic Preservation Division, New Mexico Office of Cultural Affairs >>Complete HCPI Form 1 before Form 2<<

For HPD Office use only: HCPI No.  District No.  LOCAL REFERENCE NUMBER: 2005042  
NAME OF PROPERTY: Paseo del Pueblo Norte 520 - First Indian Baptist LOCATION OF PROPERTY: 520 PASEO DEL PUEBLO NOR  
COUNTY: Taos CITY OR TOWN: Taos DATE OF SURVEY: 3/11/2005

## ARCHITECTURAL AND CONSTRUCTION DETAILS

STORIES ABOVE GRADE? 1.0

### **CONSTRUCTION MATERIAL:**

PRIMARY VISIBLE CONSTRUCTION MATERIAL:  
NOTES ON VISIBLE CONSTRUCTION MATERIAL:

### **FOUNDATION:**

" Not Available"

### **GENERAL: Notes**

*Details*

" Not Available"

### **EXTERIOR: Notes**

*Details*

**Buttresses** East and west elevations.

### **ROOF: Notes**

*Details*

**Flat Parapet**

### **DOORS: Notes**

*Details*

recessed with an adzed lintel.

**Wood  
Carved  
Panel** double

### **WINDOWS: Notes**

*Details*

3-lite steel casement units set in triplicate with purple glass,

**Exposed lintels  
Casement**

### **PORCHES/PORTALES: Notes**

*Details*

Not Available

### **CHIMNEYS: Notes**

*Details*

Not Available

### **EXTERIOR WALLS : Notes**

*Details*

Not Available

### **LANDSCAPING: Notes**

*Details*

Not Available

OTHER SIGNIFICANT FEATURES Describe unique features.)

[Empty box for other significant features]

MODIFICATIONS: (For each entry, indicate source of the date. Enter "surveyor" if it is your own. If prior survey, give date.)

[Empty box for modifications]

PRIMARY ARCHITECTURAL STYLE:

Spanish Pueblo Mission Style

this is a public building in a commercial area where most of the structures were built for residential purposes

SITE PLAN:

(Include footprint of building, porches and balconies, major landscape features, associated properties, walls, fences, gates, nearby roads, driveways, and north arrow.)

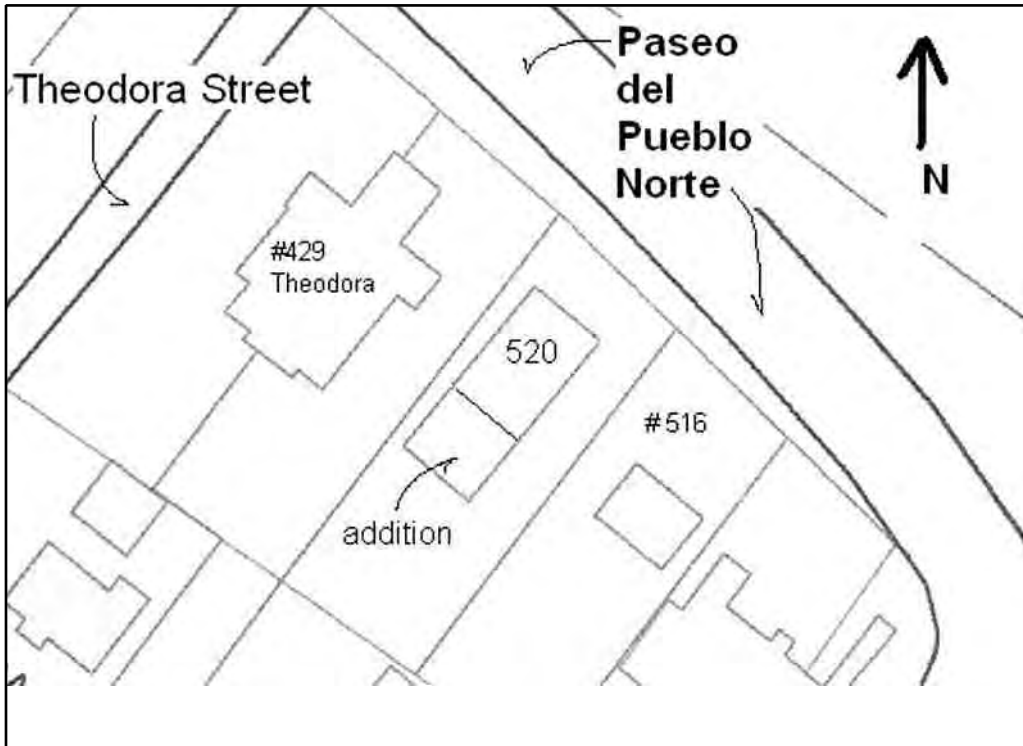

LOCATION OF, AND AVAILABLE DOCUMENTS

(Plans, histories, oral histories, maps, aerial photos, bibliographic references, etc. and where they can be found.)

[Empty box for location and available documents]

SITE PLAN NOTES:

Site. Base map provided by Taos GIS. NTS.

ATTACHED OR ASSOCIATED PROPERTIES: (List and describe. Indicate whether surveys exist for these and provide survey numbers if known.)

DESCRIPTION OF ATTACHED OR ASSOCIATED PROPERTIES

The building to the east of this structure [516 Paseo del Pueblo Norte] appears to have been built as the parsonage for the church.

IF SO, ARE THEY ELIGIBLE FOR LISTING?: None