

Historic Cultural Properties Inventory (HCPI) Base Form (FORM 1)

Historic Preservation Division, New Mexico Office of Cultural Affairs

For HPD Office use only: HCPI No. District No. NRHP: SRCP: Criteria: A B C D

NAME OF PROPERTY: Paseo del Pueblo Norte 536 - Johnson
Blacksmith Shop/Arriba Mortgage

LOCAL REFERENCE NUMBER: 2005046

LOCATION OF PROPERTY: 536 PASEO DEL PUEBLO NORTE

UTM ZONE:

CITY OR TOWN: Taos

UTM EASTING:

COUNTY: Taos

UTM NORTHING:

DATE OF SURVEY:

3/11/2005

PREVIOUS SURVEY?

Not Available

PREVIOUS SURVEY DATE:

Not Available

NAME OF PROJECT:

2005 CLG Survey

PHOTOGRAPH:

ROLL NUMBER:

FRAME NUMBER:

NEGATIVE LOCATION:



PROPERTY TYPE: Primary

PHOTOGRAPH VIEW: west elevation

DESCRIPTION OF PROPERTY:

536 Paseo del Pueblo Norte is a single story Spanish Pueblo Revival style stuccoed commercial building with a flat parapet that steps along the north and east sides. Windows are single lite double-hung wooden units with metal grilles. There is a multi-lite bay window on the east elevation under the full-width shed-roofed portal. This portal extends on the south and provides partial coverage to the courtyard on this side of the structure. There is a second portal on the rear of the building; it is a recessed corner portal with a shed roof, round posts, and corbel "blocks." Single leaf metal panel doors provide access to the building under each portal. The building sits at street grade at the sidewalk. Parking is to the rear of the building.

CONSTRUCTION DATE KNOWN? Yes SOURCE FOR CONSTRUCTION DATE: Roy Sharfin

CONSTRUCTION DATE: 1930 to 1940

SIGNIFICANT MODIFICATIONS? apparent addition on west/rear

NOTES ON CONDITION: Similar

WHO USES THE PROPERTY?: Bridges Project for Education, Arriba Mortgage Inc.

SETTING: Urban

RELATIONSHIP TO SURROUNDINGS: Similar

IF URBAN SETTING, NATURE OF IT:

COMMENTS ON SURROUNDINGS:

Commercial

ADDITIONAL PERSPECTIVE: (Photo, drawing, footprint, etc.; indicate north arrow when possible)



NOTES ON ADDITIONAL PERSPECTIVE: north and east elevations
(If photo, include photo info, as in #10)

SURVEYOR BUSINESS NAME: **Ragins Research and Planning**
 SURVEYOR FIRST NAME: **Mary**
 SURVEYOR LAST NAME: **Ragins**
 SURVEYOR STREET ADDRESS: **9 Stone ridge Road**
 SURVEYOR CITY: **Santa Fe**

OWNER OR OTHER KNOWLEDGEABLE PEOPLE:
Roy Sharfin

SURVEYOR ZIP CODE: **87505**
 SURVEYOR TELEPHONE: **575.995.0852**
 SURVEYOR EMAIL:

IS THE PROPERTY ENDANGERED?: **NO**
 HOW IS THE PROPERTY ENDANGERED?:

According to research undertaken by Peter Mackaness, this structure was built as a blacksmith shop for the Johnson family who occupied 534 Paseo del Pueblo Norte in the 1930s. It stands on Tract 62, #1-074-149-464-272 at the edge of the Historic Overlay Zone.

SIGNIFICANCE TO CURRENT COMMUNITY: **High**

DESCRIPTION OF COMMUNITY SIGNIFICANCE: **intact architectural integrity**

OTHER INFORMATION OF INTEREST: (Such as historical, legendary, structural, former ownership, etc.)

According to research undertaken by Peter Mackaness, this structure was built as a blacksmith shop for the Johnson family who occupied 534 Paseo del Pueblo Norte in the 1930s. It stands on Tract 62, #1-074-149-464-272 at the edge of the Historic Overlay Zone.

Construction Date From: Mary Shriver interview by Peter Mackaness

Individual Building Status

IS PROPERTY INDIVIDUALLY LISTED ON A REGISTER?:

INDIVIDUALLY LISTED ON SRCP?: **NO**

INDIVIDUALLY LISTED ON NRHP?: **NO**

IF NOT LISTED, IS IT ELIGIBLE?:

IF ELIGIBLE, WHY?:

Building Located In A Special Historic District?

IS PROPERTY IN SPECIAL HISTORIC DISTRICT? **YES**

DISTRICT NAME AND STATUS:

Taos Downtown Historic District - SRCP **NO**

La Loma Plaza Historic District - SRCP **NO**

Taos Historic Overlay Zone - Taos Only **YES**

Historic Cultural Properties Inventory (HCPI) Detail Form (Form 2)

Historic Preservation Division, New Mexico Office of Cultural Affairs >>Complete HCPI Form 1 before Form 2<<

For HPD Office use only: HCPI No. District No. LOCAL REFERENCE NUMBER: 2005046

NAME OF PROPERTY: Paseo del Pueblo Norte 536 - Johnson Blacksmith LOCATION OF PROPERTY: 536 PASEO DEL PUEBLO NOR
COUNTY: Taos CITY OR TOWN: Taos DATE OF SURVEY: 3/11/2005

ARCHITECTURAL AND CONSTRUCTION DETAILS

STORIES ABOVE GRADE? 1.0

CONSTRUCTION MATERIAL:

PRIMARY VISIBLE CONSTRUCTION MATERIAL:

NOTES ON VISIBLE CONSTRUCTION MATERIAL: The building sits at street grade at the sidewalk. Parking is to the rear of the buil

FOUNDATION:

" Not Available"

GENERAL: Notes

Details

" Not Available"

EXTERIOR: Notes

Details

The building sits at street grade at the sidewalk. Parking is to the rear of the building.

Parking Area

ROOF: Notes

Details

Stepped Parapet north and east sides.

DOORS: Notes

Details

Not Available

WINDOWS: Notes

Details

multi-lite bay window on the east elevation under the full-width shed -roofed portal.

Double Hung
Metal grills
Divided Light

PORCHES/PORTALES: Notes

Details

shed roof

Round Posts
Corbels
Exposed Lintels

CHIMNEYS: Notes

Details

Not Available

EXTERIOR WALLS : Notes

Details

Not Available

LANDSCAPING: Notes

Details

Not Available

LOCAL REFERENCE NUMBER:

OTHER SIGNIFICANT FEATURES Describe unique features.)

[Empty box for other significant features]

MODIFICATIONS: (For each entry, indicate source of the date. Enter "surveyor" if it is your own. If prior survey, give date.)

[Empty box for modifications]

PRIMARY ARCHITECTURAL STYLE:

single story commercial corridor

Spanish-Pueblo Revival

SITE PLAN:

(Include footprint of building, porches and balconies, major landscape features, associated properties, walls, fences, gates, nearby roads, driveways, and north arrow.)

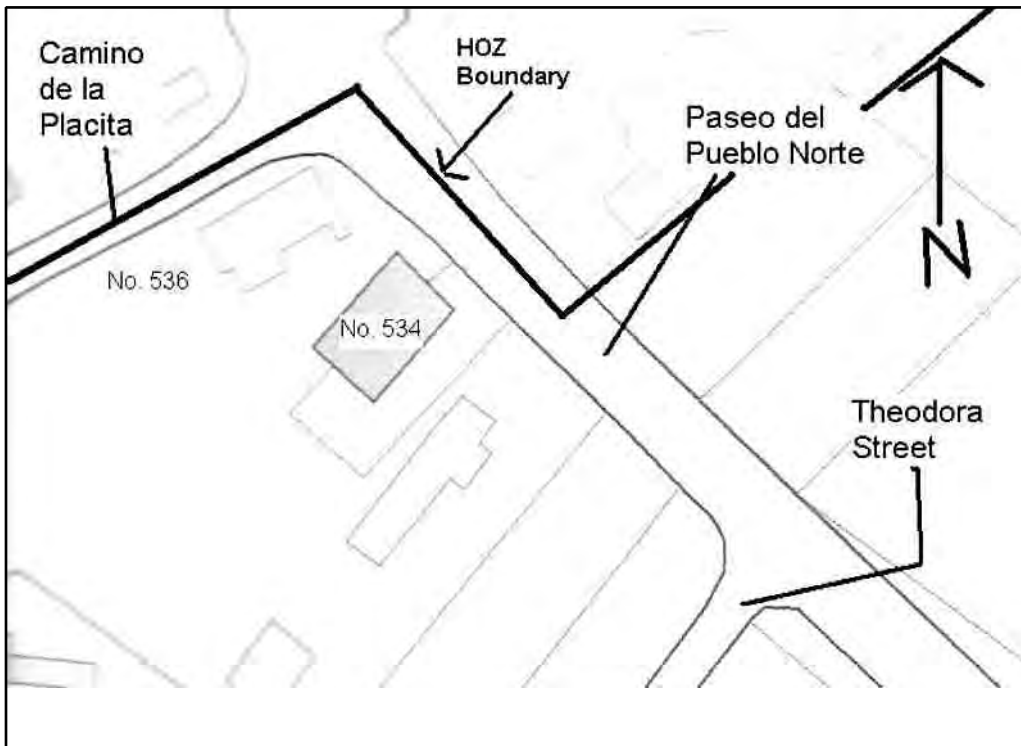

LOCATION OF, AND AVAILABLE DOCUMENTS

(Plans, histories, oral histories, maps, aerial photos, bibliographic references, etc. and where they can be found.)

[Empty box for location of and available documents]

SITE PLAN NOTES:

Site. Base map provided by Taos GIS. NTS.

ATTACHED OR ASSOCIATED PROPERTIES:

(List and describe. Indicate whether surveys exist for these and provide survey numbers if known.)

DESCRIPTION OF ATTACHED OR ASSOCIATED PROPERTIES

According to research undertaken by Peter Mackaness, this structure was built as a blacksmith shop for the Johnson family who occupied 534 Paseo del Pueblo Norte in the 1930s. It stands on Tract 62, #1-074-149-464-272 at the edge of the Historic Overlay Zone.

IF SO, ARE THEY ELIGIBLE FOR LISTING?: None