

Historic Cultural Properties Inventory (HCPI) Base Form (FORM 1)

Historic Preservation Division, New Mexico Office of Cultural Affairs

For HPD Office use only: HCPI No. District No. NRHP: SRCP: Criteria: A B C D

NAME OF PROPERTY: **Camino de la Placita 310 - Taos Elementary School**

LOCAL REFERENCE NUMBER: **2005063**

LOCATION OF PROPERTY: **310 CAMINO DE LA PLACITA**

UTM ZONE:

CITY OR TOWN: **Taos**

UTM EASTING:

COUNTY: **Taos**

UTM NORTHING:

DATE OF SURVEY:

3/12/2005

PREVIOUS SURVEY?

Not Available

PREVIOUS SURVEY DATE:

Not Available

NAME OF PROJECT:

2005 CLG Survey

PHOTOGRAPH:

ROLL NUMBER:

FRAME NUMBER:

NEGATIVE LOCATION:



PROPERTY TYPE: **Primary**

PHOTOGRAPH VIEW: **east elevation detail of central area/original building**

DESCRIPTION OF PROPERTY:

310 Camino de la Placita is a single story stuccoed institutional/school building with a flat parapet and blocked massing. The central/original portion of the building has stationary 5-lite metal horizontal windows with a lower operable awning unit placed in the walls singularly and in multiple sets. The main entrance is recessed within a projecting bay centrally located on the east elevation. Doors are double leaf metal with a large undivided window and a divided lite transom area. The southeast wing is a taller mass with minimal window openings and a roof that sheds to the south behind a flat parapet. The exterior design suggests that this may serve as the gymnasium and cafeteria. The northeast wing has a curved south wall with a recessed entrance and a single leaf metal entrance door with a vertical window and transom. There is decorative yellow tile banding below the parapet. The wing may house the school auditorium. Windows on the west side of the south wing area metal sliders in wooden frames. Sills are stuccoed. Additions on the structure create courtyard spaces on both the east and west sides of the

CONSTRUCTION DATE KNOWN? **Yes** SOURCE FOR CONSTRUCTION DATE: **TAOS MUNICIPAL SCHOOLS**

CONSTRUCTION DATE: **-1 to 1952**

SIGNIFICANT MODIFICATIONS? **post 1957 additions on west elevation creating courtyard, and on northeast and southeast corners**

NOTES ON CONDITION: **Fair**

WHO USES THE PROPERTY?: **Taos public school administration**

SETTING: **Urban**

RELATIONSHIP TO SURROUNDINGS: **Similar**

IF URBAN SETTING, NATURE OF IT:

COMMENTS ON SURROUNDINGS:

ADDITIONAL PERSPECTIVE: (Photo, drawing, footprint, etc.; indicate north arrow when possible)



NOTES ON ADDITIONAL PERSPECTIVE: **west elevation**
 (If photo, include photo info, as in #10)

SURVEYOR BUSINESS NAME: **Ragins Research and Planning**
 SURVEYOR FIRST NAME: **Mary**
 SURVEYOR LAST NAME: **Ragins**
 SURVEYOR STREET ADDRESS: **9 Stone ridge Road**
 SURVEYOR CITY: **Santa Fe**

OWNER OR OTHER KNOWLEDGEABLE PEOPLE:
TAOS MUNICIPAL SCHOOLS

SURVEYOR ZIP CODE: **87505**
 SURVEYOR TELEPHONE: **575.995.0852**
 SURVEYOR EMAIL:

IS THE PROPERTY ENDANGERED?: **NO**
 HOW IS THE PROPERTY ENDANGERED?:

According to research conducted by Peter Mackaness, the 1999 aerial photo of Toas depicts the courtyard-creating western additions in place. By 2005, the additions on the east have been constructed. The encapsulation of the original structure by additions occurred 1957-1999.

SIGNIFICANCE TO CURRENT COMMUNITY: **Moderate**
 DESCRIPTION OF COMMUNITY SIGNIFICANCE: **long term historic use is important though architectural integrity has suffered**
 OTHER INFORMATION OF INTEREST: (Such as historical, legendary, structural, former ownership, etc.)

According to research conducted by Peter Mackaness, the 1999 aerial photo of Toas depicts the courtyard-creating western additions in place. By 2005, the additions on the east have been constructed. The encapsulation of the original structure by additions occurred 1957-1999.

Construction Date From: 1952 Taos aerial photo

Individual Building Status

IS PROPERTY INDIVIDUALLY LISTED ON A REGISTER?:
 INDIVIDUALLY LISTED ON SRCP?: **NO**
 INDIVIDUALLY LISTED ON NRHP?: **NO**
 IF NOT LISTED, IS IT ELIGIBLE?:
 IF ELIGIBLE, WHY?:

Building Located In A Special Historic District?

IS PROPERTY IN SPECIAL HISTORIC DISTRICT? **YES**
 DISTRICT NAME AND STATUS:
 Taos Downtown Historic District - SRCP **NO**
 La Loma Plaza Historic District - SRCP **NO**
 Taos Historic Overlay Zone - Taos Only **YES**

Historic Cultural Properties Inventory (HCPI) Detail Form (Form 2)

Historic Preservation Division, New Mexico Office of Cultural Affairs >>Complete HCPI Form 1 before Form 2<<

For HPD Office use only: HCPI No. District No. LOCAL REFERENCE NUMBER: 2005063

NAME OF PROPERTY: Camino de la Placita 310 - Taos Elementary Scho LOCATION OF PROPERTY: 310 CAMINO DE LA PLACITA
COUNTY: Taos CITY OR TOWN: Taos DATE OF SURVEY: 3/12/2005

ARCHITECTURAL AND CONSTRUCTION DETAILS

STORIES ABOVE GRADE? 1.0

CONSTRUCTION MATERIAL:

PRIMARY VISIBLE CONSTRUCTION MATERIAL:

NOTES ON VISIBLE CONSTRUCTION MATERIAL: playground areas on east and north, grassy playting fields on east.

FOUNDATION:

DOES A FOUNDATION EXIST?:

TYPE OF FOUNDATION:

FOUNDATION MATERIALS

FOUNDATION NOTES:

GENERAL: Notes

Details

310 Camino de la Placita is a single story stuccoed institutional/school building with a flat parapet and blocked massing. Southeast wing is a taller mass with minimal window openings and a roof that sheds to the south behind a flat parapet, the cafeteria. The

Details

EXTERIOR: Notes

playground areas on east and north, grassy playting fields on east.

Courtyard
Parking Area

east and west sides of building.
south and south east.

Details

ROOF: Notes

Flat
Flat Parapet
Canales

Details

DOORS: Notes

Doors are double leaf metal with a large undivided window and a divided lite transom area., recessed within a projecting bay centrally located with sidelights located on the east elevation and north and south interior portions of west courtyard.

Windows/Lites
Metal

Details

WINDOWS: Notes

Windows on the west side of the south wing area metal sliders in wooden frames.

Awning
Fixed
Glazed
Slider

Details

PORCHES/PORTALES: Notes

Not Available

Details

CHIMNEYS: Notes

Not Available

Details

EXTERIOR WALLS : Notes

Not Available

Details

LANDSCAPING: Notes

Not Available

OTHER SIGNIFICANT FEATURES Describe unique features.)

Empty box for other significant features.

MODIFICATIONS: (For each entry, indicate source of the date. Enter "surveyor" if it is your own. If prior survey, give date.)

Empty box for modifications.

PRIMARY ARCHITECTURAL STYLE:

Northern New Mexico

310 Camino de la Placita is a single story stuccoed institutional/school building with a flat parapet and blocked massing. Southeast wing is a taller mass with minimal window openings and a roof that sheds to the south behind a flat parapet, the cafeteria. The northeast wing, the library, has a curved south wall with a

SITE PLAN:

(Include footprint of building, porches and balconies, major landscape features, associated properties, walls, fences, gates, nearby roads, driveways, and north arrow.)

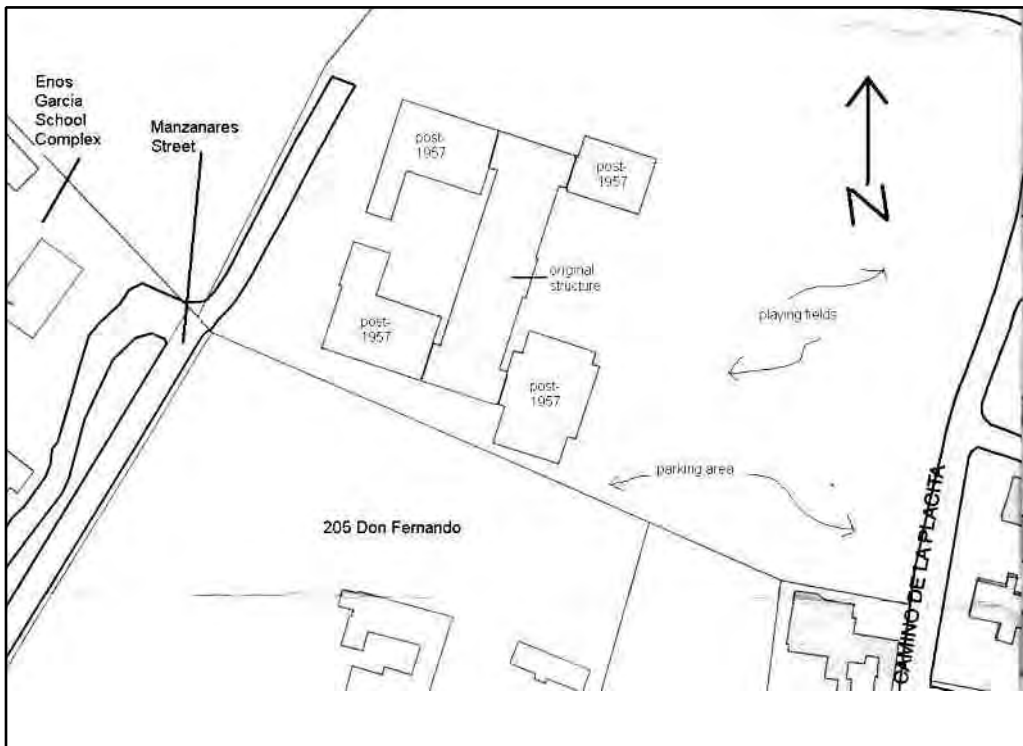

LOCATION OF, AND AVAILABLE DOCUMENTS

(Plans, histories, oral histories, maps, aerial photos, bibliographic references, etc. and where they can be found.)

Empty box for location of and available documents.

SITE PLAN NOTES:

Site. Base map provided by Taos GIS. NTS.

ATTACHED OR ASSOCIATED PROPERTIES: (List and describe. Indicate whether surveys exist for these and provide survey numbers if known.)

DESCRIPTION OF ATTACHED OR ASSOCIATED PROPERTIES

According to research conducted by Peter Mackaness, the 1999 aerial photo of Toas depicts the courtyard-creating western additions in place. By 2005, the additions on the east have been constructed. The encapsulation of the original structure by additions occurred 1957-1999.

IF SO, ARE THEY ELIGIBLE FOR LISTING?: None



2005 Survey Photo 3