

# Historic Cultural Properties Inventory (HCPI) Base Form (FORM 1)

Historic Preservation Division, New Mexico Office of Cultural Affairs

For HPD Office use only: HCPI No.  District No.   NRHP:  SRCP: Criteria:  A  B  C  D

NAME OF PROPERTY: **Padre Martinez Ln 110 - Las Casitas - Units 1 - 3** LOCAL REFERENCE NUMBER: **2005074**  
LOCATION OF PROPERTY: **110 PADRE MARTINEZ** UTM ZONE:  
CITY OR TOWN: **Taos** UTM EASTING:  
COUNTY: **Taos** UTM NORTHING:

DATE OF SURVEY:  
**3/12/2005**  
PREVIOUS SURVEY?  
**Not Available**

PREVIOUS SURVEY DATE:  
**Not Available**

NAME OF PROJECT:  
**2005 CLG Survey**

PHOTOGRAPH:  
ROLL NUMBER:

FRAME NUMBER:

NEGATIVE LOCATION:



PROPERTY TYPE: **Primary** PHOTOGRAPH VIEW: **East and north**

DESCRIPTION OF PROPERTY:

**110 Padre Martinez Lane is a single story stuccoed Spanish Pueblo Revival style residential multi-unit structure. It has a flat parapet with simply designed partial-width projecting portales marking the entry to each unit. Portales have round posts and exposed lintels. Windows are a mix of 3-lite steel casements units on the east and south elevations, and aluminum slider units on the north elevation; sills are wooden. Entrance doors are single leaf multi-panel units with wooden screen doors. There are decorative canales at the parapet, and projecting vigas on the south elevation have been cut off. A low stucco landscape planter wall separates the building from the street on the east. This structure is part of a larger complex in which stand 2 additional buildings. The site has the feel of a motor-court with its central driveway passing between buildings to provide access to the rear of the lot where the third structure stands.**

CONSTRUCTION DATE KNOWN? **Yes** SOURCE FOR CONSTRUCTION DATE:

CONSTRUCTION DATE: to

SIGNIFICANT MODIFICATIONS?

NOTES ON CONDITION:

WHO USES THE PROPERTY?:

SETTING: **Urban**

RELATIONSHIP TO SURROUNDINGS **Similar**

IF URBAN SETTING, NATURE OF IT:

COMMENTS ON SURROUNDINGS:

ADDITIONAL PERSPECTIVE: (Photo, drawing, footprint, etc.; indicate north arrow when possible)

[Large empty rectangular box for additional perspective]

NOTES ON ADDITIONAL PERSPECTIVE: (If photo, include photo info, as in #10)

SURVEYOR BUSINESS NAME:

OWNER OR OTHER KNOWLEDGEABLE PEOPLE:

SURVEYOR FIRST NAME:

SURVEYOR LAST NAME:

SURVEYOR STREET ADDRESS:

IS THE PROPERTY ENDANGERED?: NO

SURVEYOR CITY:

HOW IS THE PROPERTY ENDANGERED?:

SURVEYOR ZIP CODE:

SURVEYOR TELEPHONE:

SURVEYOR EMAIL:

[Empty rectangular box for property endangerment details]

SIGNIFICANCE TO CURRENT COMMUNITY:

DESCRIPTION OF COMMUNITY SIGNIFICANCE:

OTHER INFORMATION OF INTEREST: (Such as historical, legendary, structural, former ownership, etc.)

[Large empty rectangular box for other information of interest]

Individual Building Status

IS PROPERTY INDIVIDUALLY LISTED ON A REGISTER?:

INDIVIDUALLY LISTED ON SRCP?: NO

INDIVIDUALLY LISTED ON NRHP?: NO

IF NOT LISTED, IS IT ELIGIBLE?:

IF ELIGIBLE, WHY?:

[Empty rectangular box for eligibility reasons]

Building Located In A Special Historic District?

IS PROPERTY IN SPECIAL HISTORIC DISTRICT? YES

DISTRICT NAME AND STATUS:

Taos Downtown Historic District - SRCP YES

La Loma Plaza Historic District - SRCP NO

Taos Historic Overlay Zone - Taos Only YES

# Historic Cultural Properties Inventory (HCPI) Detail Form (Form 2)

Historic Preservation Division, New Mexico Office of Cultural Affairs >>Complete HCPI Form 1 before Form 2<<

For HPD Office use only: HCPI No.  District No.  LOCAL REFERENCE NUMBER: 2005074  
NAME OF PROPERTY: Padre Martinez Ln 110 - Las Casitas - Units 1 - 3 LOCATION OF PROPERTY: 110 PADRE MARTINEZ  
COUNTY: Taos CITY OR TOWN: Taos DATE OF SURVEY: 3/12/2005

## ARCHITECTURAL AND CONSTRUCTION DETAILS

STORIES ABOVE GRADE? 1.0

### **CONSTRUCTION MATERIAL:**

Not Available

### **FOUNDATION:**

DOES A FOUNDATION EXIST?:

TYPE OF FOUNDATION:

FOUNDATION MATERIALS **General**

FOUNDATION NOTES:

#### **GENERAL: Notes**

*Details*

Residential multi-unit structure. This structure is part of a larger complex in which stand 2 additional buildings. The site has the feel of a motor-court with its central driveway passing between buildings to provide access to the rear of the lot where the third structure

#### **EXTERIOR: Notes**

*Details*

Not Available

#### **ROOF: Notes**

*Details*

Flat  
Flat Parapet  
Canales

decorative

#### **DOORS: Notes**

*Details*

Entrance doors are single leaf multi-panel units with wooden screen doors.

#### **WINDOWS: Notes**

*Details*

Mix of 3-lite steel casements units on the east and south elevations, and aluminum slider units on the north elevation; sills are wooden.

Casement  
Slider  
Glazed

#### **PORCHES/PORTALES: Notes**

*Details*

simply-designed partial-width projecting portales marking the entry to each unit.

Partial  
Exposed Lintels  
Round Posts

#### **CHIMNEYS: Notes**

*Details*

Not Available

#### **EXTERIOR WALLS : Notes**

*Details*

A low stucco landscape planter wall separates the building from the street on the east.

Stucco

#### **LANDSCAPING: Notes**

*Details*

Not Available

OTHER SIGNIFICANT FEATURES Describe unique features.)

[Empty box for other significant features]

MODIFICATIONS: (For each entry, indicate source of the date. Enter "surveyor" if it is your own. If prior survey, give date.)

[Empty box for modifications]

PRIMARY ARCHITECTURAL STYLE:

Spanish-Pueblo Revival

Residential multi-unit structure. This structure is part of a larger complex in which stand 2 additional buildings. The site has the feel of a motor-court with its central driveway passing between buildings to provide access to the rear of the lot where the third structure stands. No obvious maintenance needs.

SITE PLAN:

(Include footprint of building, porches and balconies, major landscape features, associated properties, walls, fences, gates, nearby roads, driveways, and north arrow.)

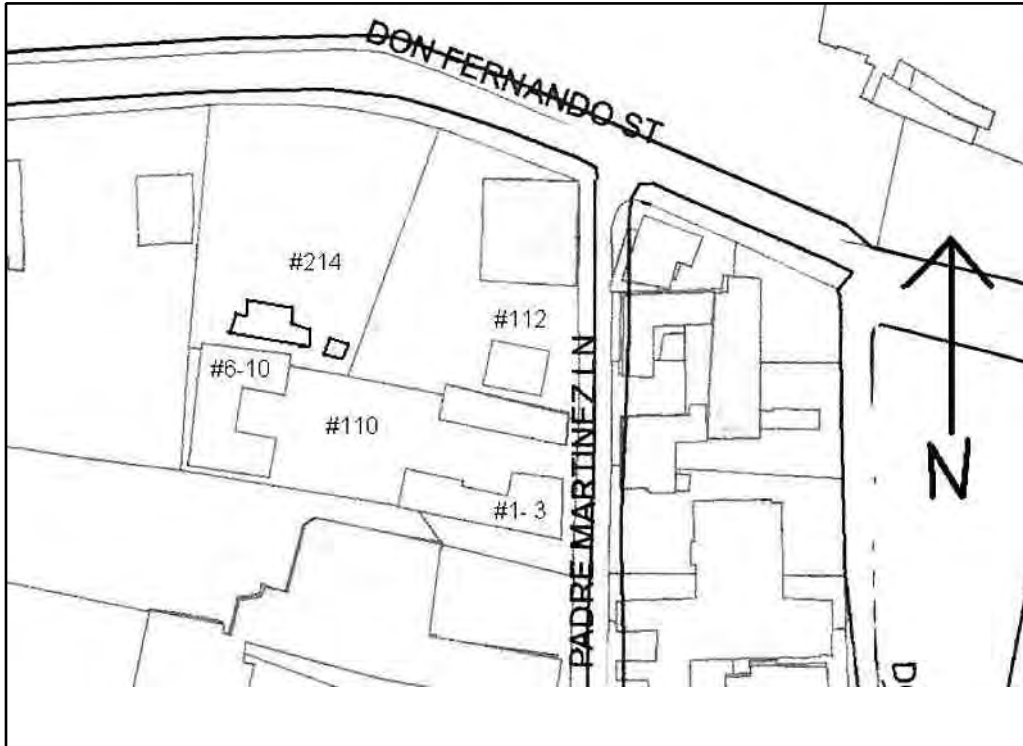

LOCATION OF, AND AVAILABLE DOCUMENTS

(Plans, histories, oral histories, maps, aerial photos, bibliographic references, etc. and where they can be found.)

[Empty box for location of documents]

SITE PLAN NOTES:

Site. Base map provided by Taos GIS. NTS.

ATTACHED OR ASSOCIATED PROPERTIES:

(List and describe. Indicate whether surveys exist for these and provide survey numbers if known.)

DESCRIPTION OF ATTACHED OR ASSOCIATED PROPERTIES

This structure was previously surveyed as # 022502010 in both 1981 and 1996. It is likely that which is illustrated on the 1939 Sanborn Fire Insurance Company map as a "L"-shaped structure with the leg of the "L" fronting on the street. Modern renovation work has impacted though not

IF SO, ARE THEY ELIGIBLE FOR LISTING?: None