

# Historic Cultural Properties Inventory (HCPI) Base Form (FORM 1)

Historic Preservation Division, New Mexico Office of Cultural Affairs

For HPD Office use only: HCPI No.  District No.   NRHP:  SRCP: Criteria:  A  B  C  D

NAME OF PROPERTY: **Padre Martinez Ln 110 - Las Casitas - Units 6-10** LOCAL REFERENCE NUMBER: **2005075**  
LOCATION OF PROPERTY: **110 PADRE MARTINEZ** UTM ZONE:  
CITY OR TOWN: **Taos** UTM EASTING:  
COUNTY: **Taos** UTM NORTHING:

DATE OF SURVEY:  
**3/12/2005**  
PREVIOUS SURVEY?  
**Not Available**

PREVIOUS SURVEY DATE:  
**Not Available**

NAME OF PROJECT:  
**2005 CLG Survey**

PHOTOGRAPH:  
ROLL NUMBER:

FRAME NUMBER:

NEGATIVE LOCATION:



PROPERTY TYPE: **Primary** PHOTOGRAPH VIEW: **east**

DESCRIPTION OF PROPERTY:

**110 Padre Martinez Lane [Units 6 – 10] is a single story stuccoed Spanish Pueblo Revival style U-shaped multi-unit residential structure that sits at the rear of the lot. It has a flat parapet that conceals shed roofs on the north and south wings. Windows are wooden double hung units in the 1-over-1 configuration. There is a trellis "portal" in the "U" area with simple posts and corbels. Entrance to each unit is through a single leaf wooden multi-panel door on each unit. The building has exposed viga ends, and canales which project through the east elevation parapets. Three chimneys are visible on the roof. There is an undulating courtyard wall across the "U" that has latillas filled openings. A small shed-roofed mechanical room is attached to the northeast corner of the building. This structure is part of a larger complex in which stand 2 additional buildings. The site has the feel of a motor-court with its central driveway passing between buildings to provide access to the rear of the lot where this structure stands.**

CONSTRUCTION DATE KNOWN? **Yes** SOURCE FOR CONSTRUCTION DATE:

CONSTRUCTION DATE: to

SIGNIFICANT MODIFICATIONS?

NOTES ON CONDITION:

WHO USES THE PROPERTY?:

SETTING: **Urban**

RELATIONSHIP TO SURROUNDINGS **Similar**

IF URBAN SETTING, NATURE OF IT:

COMMENTS ON SURROUNDINGS:

ADDITIONAL PERSPECTIVE: (Photo, drawing, footprint, etc.; indicate north arrow when possible)

[Large empty rectangular box for additional perspective]

NOTES ON ADDITIONAL PERSPECTIVE: (If photo, include photo info, as in #10)

SURVEYOR BUSINESS NAME:

OWNER OR OTHER KNOWLEDGEABLE PEOPLE:

SURVEYOR FIRST NAME:

SURVEYOR LAST NAME:

SURVEYOR STREET ADDRESS:

IS THE PROPERTY ENDANGERED?: NO

SURVEYOR CITY:

HOW IS THE PROPERTY ENDANGERED?:

SURVEYOR ZIP CODE:

[Empty rectangular box for property endangerment details]

SURVEYOR TELEPHONE:

SURVEYOR EMAIL:

SIGNIFICANCE TO CURRENT COMMUNITY:

DESCRIPTION OF COMMUNITY SIGNIFICANCE:

OTHER INFORMATION OF INTEREST: (Such as historical, legendary, structural, former ownership, etc.)

[Large empty rectangular box for other information of interest]

Individual Building Status

IS PROPERTY INDIVIDUALLY LISTED ON A REGISTER?:

INDIVIDUALLY LISTED ON SRCP?: NO

INDIVIDUALLY LISTED ON NRHP?: NO

IF NOT LISTED, IS IT ELIGIBLE?:

IF ELIGIBLE, WHY?:

[Empty rectangular box for eligibility reasons]

Building Located In A Special Historic District?

IS PROPERTY IN SPECIAL HISTORIC DISTRICT? YES

DISTRICT NAME AND STATUS:

Taos Downtown Historic District - SRCP YES

La Loma Plaza Historic District - SRCP NO

Taos Historic Overlay Zone - Taos Only YES

# Historic Cultural Properties Inventory (HCPI) Detail Form (Form 2)

Historic Preservation Division, New Mexico Office of Cultural Affairs >>Complete HCPI Form 1 before Form 2<<

For HPD Office use only: HCPI No.  District No.  LOCAL REFERENCE NUMBER: 2005075  
NAME OF PROPERTY: Padre Martinez Ln 110 - Las Casitas - Units 6-10 LOCATION OF PROPERTY: 110 PADRE MARTINEZ  
COUNTY: Taos CITY OR TOWN: Taos DATE OF SURVEY: 3/12/2005

## ARCHITECTURAL AND CONSTRUCTION DETAILS

STORIES ABOVE GRADE? 1.0

### **CONSTRUCTION MATERIAL:**

PRIMARY VISIBLE CONSTRUCTION MATERIAL: Adobe

NOTES ON VISIBLE CONSTRUCTION MATERIAL: A small shed-roofed mechanical room is attached to the northeast corner of the

### **FOUNDATION:**

DOES A FOUNDATION EXIST?:

TYPE OF FOUNDATION:

FOUNDATION MATERIALS

FOUNDATION NOTES:

### **GENERAL: Notes**

*Details*

U-shaped multi-unit residential structure that sits at the rear of the lot. No obvious maintenance needs

### **EXTERIOR: Notes**

*Details*

A small shed-roofed mechanical room is attached to the northeast corner of the building. This structure is part of a larger complex in which stand 2 additional buildings. The site has the feel of a motor-court with its central driveway passing between buildings to provide

Exposed Vigas

central courtyard

### **ROOF: Notes**

*Details*

Flat Parapet  
Low  
Canales

shed roofs on north and south w  
east elevation

### **DOORS: Notes**

*Details*

single leaf wooden multi-panel door on each unit.

Wood  
Panel

multi-panel

### **WINDOWS: Notes**

*Details*

1 over 1

Double Hung

### **PORCHES/PORTALES: Notes**

*Details*

trellis-style

Corbels  
Round Posts

### **CHIMNEYS: Notes**

*Details*

### **EXTERIOR WALLS : Notes**

*Details*

undulating courtyard wall across the "U" that has latilla-filled openings.

### **LANDSCAPING: Notes**

*Details*

Not Available

OTHER SIGNIFICANT FEATURES Describe unique features.)

[Empty box for other significant features]

MODIFICATIONS: (For each entry, indicate source of the date. Enter "surveyor" if it is your own. If prior survey, give date.)

[Empty box for modifications]

PRIMARY ARCHITECTURAL STYLE:

Spanish-Pueblo Revival

U-shaped multi-unit residential structure that sits at the rear of the lot. No obvious maintenance needs

SITE PLAN:

(Include footprint of building, porches and balconies, major landscape features, associated properties, walls, fences, gates, nearby roads, driveways, and north arrow.)

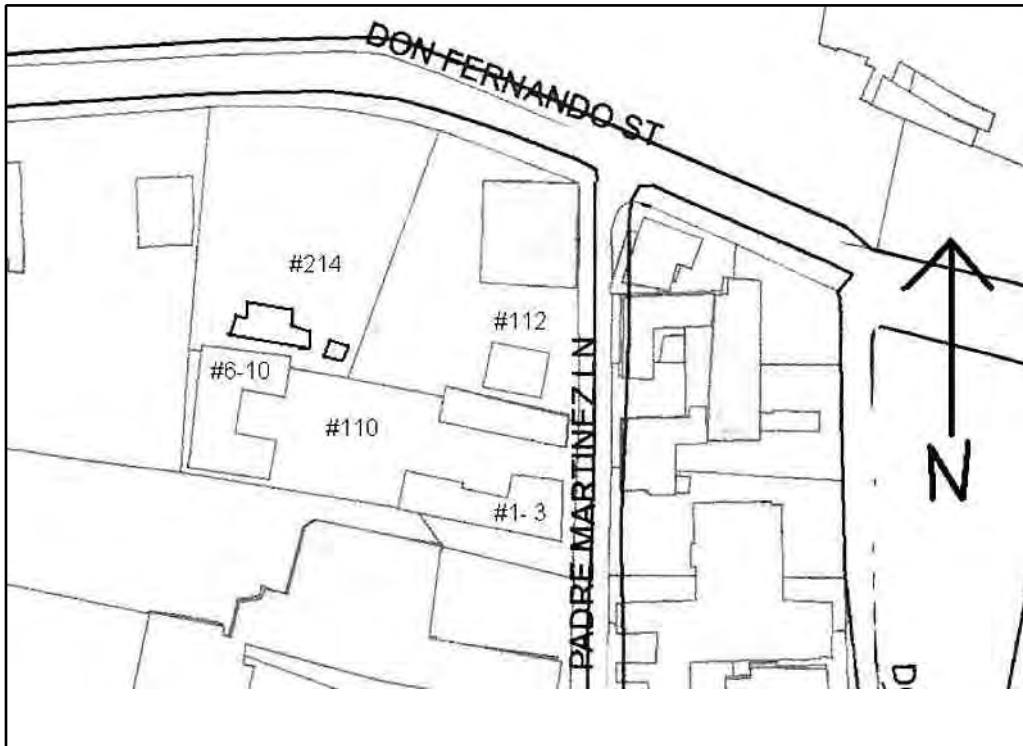

LOCATION OF, AND AVAILABLE DOCUMENTS

(Plans, histories, oral histories, maps, aerial photos, bibliographic references, etc. and where they can be found.)

[Empty box for location of documents]

SITE PLAN NOTES:

Site. Base map provided by Taos GIS. NTS.

ATTACHED OR ASSOCIATED PROPERTIES: (List and describe. Indicate whether surveys exist for these and provide survey numbers if known.)

DESCRIPTION OF ATTACHED OR ASSOCIATED PROPERTIES

Building was surveyed in 1996 as #022502123. The construction of this unit enclosed the compound on the west side. It sits at the rear of the property. Research performed by Peter Mackaness states that the structure was built in 1982.

IF SO, ARE THEY ELIGIBLE FOR LISTING?: None