

Historic Cultural Properties Inventory (HCPI) Base Form (FORM 1)

Historic Preservation Division, New Mexico Office of Cultural Affairs

For HPD Office use only: HCPI No. District No. NRHP: SRCP: Criteria: A B C D

NAME OF PROPERTY: **La Loma Plaza 103**

LOCAL REFERENCE NUMBER: **022501030**

LOCATION OF PROPERTY: **103 LA LOMA**

UTM ZONE:

CITY OR TOWN: **Taos**

UTM EASTING:

COUNTY: **Taos**

UTM NORTHING:

DATE OF SURVEY:

8/1/1981

PREVIOUS SURVEY?

Not Available

PREVIOUS SURVEY DATE:

Not Available

NAME OF PROJECT:

1981 CLG Survey

PHOTOGRAPH:

ROLL NUMBER:

FRAME NUMBER:

NEGATIVE LOCATION:



PROPERTY TYPE:

PHOTOGRAPH VIEW: **older**

DESCRIPTION OF PROPERTY:

CONSTRUCTION DATE KNOWN? **Yes** SOURCE FOR CONSTRUCTION DATE:

CONSTRUCTION DATE: _____ to _____

SIGNIFICANT MODIFICATIONS?

NOTES ON CONDITION:

WHO USES THE PROPERTY?:

SETTING:

IF URBAN SETTING, NATURE OF IT: **Residential**

RELATIONSHIP TO SURROUNDINGS:

Similar

COMMENTS ON SURROUNDINGS:

ADDITIONAL PERSPECTIVE: (Photo, drawing, footprint, etc.; indicate north arrow when possible)

[Large empty rectangular box for additional perspective]

NOTES ON ADDITIONAL PERSPECTIVE:

(If photo, include photo info, as in #10)

SURVEYOR BUSINESS NAME:

OWNER OR OTHER KNOWLEDGEABLE PEOPLE:

SURVEYOR FIRST NAME:

SURVEYOR LAST NAME:

SURVEYOR STREET ADDRESS:

IS THE PROPERTY ENDANGERED?: NO

SURVEYOR CITY:

HOW IS THE PROPERTY ENDANGERED?:

SURVEYOR ZIP CODE:

SURVEYOR TELEPHONE:

SURVEYOR EMAIL:

[Empty rectangular box for property endangerment details]

SIGNIFICANCE TO CURRENT COMMUNITY:

DESCRIPTION OF COMMUNITY SIGNIFICANCE:

OTHER INFORMATION OF INTEREST: (Such as historical, legendary, structural, former ownership, etc.)

[Empty rectangular box for other information of interest]

Individual Building Status

IS PROPERTY INDIVIDUALLY LISTED ON A REGISTER?:

INDIVIDUALLY LISTED ON SRCP?: NO

INDIVIDUALLY LISTED ON NRHP?: NO

IF NOT LISTED, IS IT ELIGIBLE?:

IF ELIGIBLE, WHY?:

[Empty rectangular box for eligibility details]

Building Located In A Special Historic District?

IS PROPERTY IN SPECIAL HISTORIC DISTRICT? YES

DISTRICT NAME AND STATUS:

Taos Downtown Historic District - SRCP NO

La Loma Plaza Historic District - SRCP YES

Taos Historic Overlay Zone - Taos Only YES

Historic Cultural Properties Inventory (HCPI) Detail Form (Form 2)

Historic Preservation Division, New Mexico Office of Cultural Affairs >>Complete HCPI Form 1 before Form 2<<

For HPD Office use only: HCPI No. District No. LOCAL REFERENCE NUMBER: 022501030
NAME OF PROPERTY: La Loma Plaza 103 LOCATION OF PROPERTY: 103 LA LOMA
COUNTY: Taos CITY OR TOWN: Taos DATE OF SURVEY: 8/1/1981

ARCHITECTURAL AND CONSTRUCTION DETAILS

STORIES ABOVE GRADE? 1.0

CONSTRUCTION MATERIAL:

PRIMARY VISIBLE CONSTRUCTION MATERIAL: Adobe

NOTES ON VISIBLE CONSTRUCTION MATERIAL:

FOUNDATION:

" Not Available"

GENERAL: Notes

LaLoma Plaza

Details

EXTERIOR: Notes

Details

ROOF: Notes

Not Available

Details

DOORS: Notes

Not Available

Details

WINDOWS: Notes

Not Available

Details

PORCHES/PORTALES: Notes

Not Available

Details

CHIMNEYS: Notes

Not Available

Details

EXTERIOR WALLS : Notes

Not Available

Details

LANDSCAPING: Notes

Not Available

Details

LOCAL REFERENCE NUMBER:

OTHER SIGNIFICANT FEATURES Describe unique features.)

Empty box for other significant features.

MODIFICATIONS: (For each entry, indicate source of the date. Enter "surveyor" if it is your own. If prior survey, give date.)

Empty box for modifications.

PRIMARY ARCHITECTURAL STYLE:

LaLoma Plaza

Unknown or N/A

SITE PLAN:

(Include footprint of building, porches and balconies, major landscape features, associated properties, walls, fences, gates, nearby roads, driveways, and north arrow.)

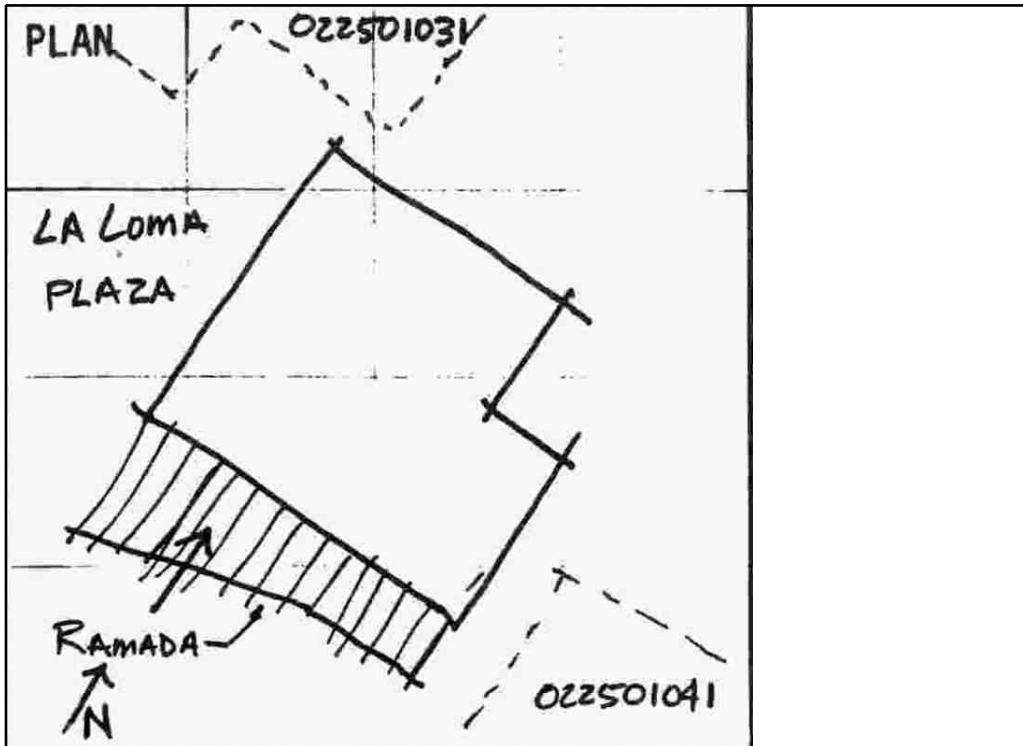

LOCATION OF, AND AVAILABLE DOCUMENTS

(Plans, histories, oral histories, maps, aerial photos, bibliographic references, etc. and where they can be found.)

Empty box for location of and available documents.

SITE PLAN NOTES:

Empty box for site plan notes.

Attached/Associated Properties Information Not Available